

MBN40x10R-4FW

Call 800-321-7800 or visit us online at www.nookindustries.com to configure and order your MBN40x10R-4FW today!

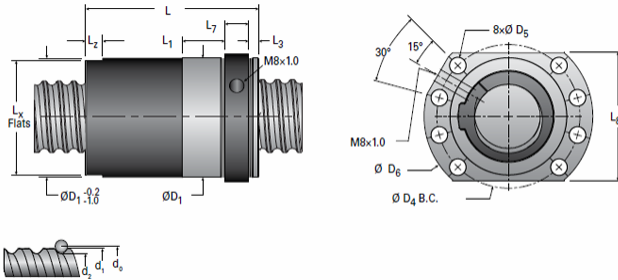

Product Info

| | |
|---------------------------|-------|
| Nominal Rod Diameter [mm] | 40 |
| Material | Alloy |
| Thread Direction | RH |

Details

| | |
|-------------------------------|-------|
| Lead [mm] | 10 |
| Active Turns | 4 |
| Nominal Ball Dia. [mm] | 7.144 |
| Screw Weight [kg/m] | 8.65 |
| Nut Weight [kg] | 1.31 |
| Lube Hole Locaton | - |
| End Code for Types 1,2, and 3 | 30 |
| End Code for Types 4 | 19 |
| End Code for Types 5 | 25 |
| End Code for Types 6 | 30 |
| End Code for Types 7 | 30 |

Performance Specifications

| | |
|--|--------|
| Dynamic Load Ca [N] | 56770 |
| Static Load [N] | 116070 |
| Linear Speed (Based on DN Values) [mm/min] | 16700 |

Screw Dimensions

| | |
|---------|-------|
| d0 [mm] | 42.1 |
| d1 [mm] | 40.00 |
| d2 [mm] | 34.81 |

Nut Dimensions

| | |
|---------------|-------|
| D1 (g6) [mm] | 63 |
| L [mm] | 93 |
| L1 [mm] | 20 |
| Lx [mm] | 60 |
| Lz [mm] | 10 |
| L3 (min) [mm] | 8.5 |
| L7 [mm] | 14 |
| L8 [mm] | 70 |
| D4 [mm] | 78 |
| D5 [mm] | 8 × 9 |
| D6 [mm] | 93 |