

PowerTrac 1250 - 0500 XPR RA, with PRN Ball Nut, Preloaded

Call 800-321-7800 or visit us online at www.nookindustries.com to configure and order your PowerTrac 1250 - 0500 XPR RA, with PRN Ball Nut,

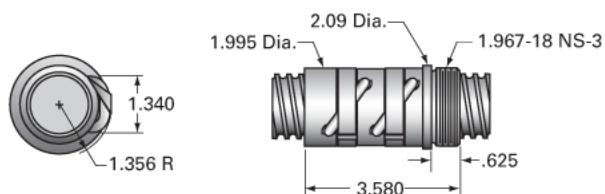

Inch Ball Screw

(Screw)Product Info

| | |
|------------------|------------------|
| Screw Code | 1250-0500 XPR RA |
| Precision | XPR |
| Screw Material | 4150 |
| Thread Direction | RH |

(Screw)Details

| | |
|---|-------|
| Ball Circle Diameter [in] | 1.250 |
| Lead [in] | 0.500 |
| Root Diameter [in] | 1.050 |
| End Code for Types 1,2,3,5 [* Journals may show tracings of the thread] | 25 |
| End Code for Type 4 [* Journals may show tracings of the thread] | 16 |

(Screw)Performance Specifications

| | |
|-----------------------------|--------|
| Lead Accuracy +/- [in./ft.] | 0.0010 |
|-----------------------------|--------|

(Screw)Part Numbers

| | |
|--------------------|--------------|
| 2 ft. Part Number | |
| 4 ft. Part Number | |
| 6 ft. Part Number | XPR12550R72 |
| 8 ft. Part Number | |
| 12 ft. Part Number | XPR12550R144 |
| 16 ft. Part Number | |
| 20 ft. Part Number | |

(Screw)Weight

| | |
|------------------------|------|
| Screw Weight [lb./ft.] | 3.70 |
|------------------------|------|

Inch Ball Nut, for SGT and XPR, Ground Accuracy, Preloaded, Fixed, PRN

(Nut)Product Info

| | |
|------------------|----------|
| Ball Nut Number | PRN10087 |
| Thread Direction | RH |

(Nut)Details

| | |
|----------------------------|-------|
| Ball Circle Diameter [in] | 1.250 |
| Lead [in] | 0.500 |
| Nominal Ball Diameter [in] | 0.188 |
| Root diameter [in] | 1.050 |

(Nut)Forces and Torques

| | |
|-------------------------------|-------|
| Torque to Raise 1 lb. [in-lb] | 0.088 |
|-------------------------------|-------|

(Nut)Flange Part Numbers

| | |
|--------------------|---------|
| Flange Part Number | FLG7572 |
|--------------------|---------|

(Nut)Wiper Part Numbers

| | |
|-----------------------|-----------|
| Wiper Kit Part Number | ELASTOMER |
|-----------------------|-----------|

(Nut)Weight

| | |
|-----------------|------|
| Nut Weight [lb] | 2.75 |
|-----------------|------|

(Nut)Performance Specifications

| | |
|---|-------|
| Maximum Adjustable Preload [lb] | |
| Spring Rate x 10 ⁶ [lb./in.] | 4.25 |
| Dynamic Load [lb] | 1765 |
| Static Load [lb] | 11080 |