

## PowerTrac 0631 - 0500 SRT RA, with SBN Ball Nut, Double Circuit

Call 800-321-7800 or visit us online at [www.nookindustries.com](http://www.nookindustries.com) to configure and order your PowerTrac 0631 - 0500 SRT RA, with SBN Ball Nut, Double

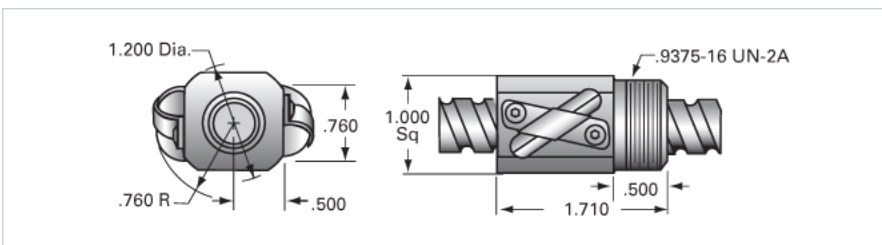

<b>Inch Ball Screw</b>	
<b>(Screw)Product Info</b>	
Screw Code	0631-0500 SRT RA
Precision	SRT
Screw Material	4150
Thread Direction	RH
<b>(Screw)Details</b>	
Ball Circle Diameter [in]	0.631
Lead [in]	0.500
Root Diameter [in]	0.500
End Code for Types 1,2,3,5 [* Journals may show tracings of the thread]	12
End Code for Type 4 [* Journals may show tracings of the thread]	8
<b>(Screw)Performance Specifications</b>	
Lead Accuracy +/- [in./ft.]	0.0040
<b>(Screw)Part Numbers</b>	
2 ft. Part Number	SRT6524
4 ft. Part Number	SRT6548
6 ft. Part Number	SRT6572
8 ft. Part Number	
12 ft. Part Number	
16 ft. Part Number	
20 ft. Part Number	
<b>(Screw)Weight</b>	
Screw Weight [lb./ft.]	0.82
<b>Inch Ball Nut, for SRT, Standard Accuracy, No Preload, SBN, Standard</b>	
<b>(Nut)Product Info</b>	
Ball Nut Number	SBN10113
Thread Direction	RH
<b>(Nut)Details</b>	
Ball Circle Diameter [in]	0.631
Lead [in]	0.500
Nominal Ball Diameter [in]	0.125
Root diameter [in]	0.500
<b>(Nut)Dimensions</b>	
A [in]	
<b>(Nut)Forces and Torques</b>	
Torque to Raise 1 lb. [in-lb]	0.088
<b>(Nut)Flange Part Numbers</b>	
Flange Part Number	FLG7570
<b>(Nut)Wiper Part Numbers</b>	
Wiper Kit Part Number	-
Wiper Kit Felt Part Number	
<b>(Nut)Weight</b>	
Nut Weight [lb]	0.27
<b>(Nut)Performance Specifications</b>	
Lead Accuracy +/- [in./ft.]	0.004
Maximum Adjustable Preload [lb]	
Spring Rate x 10 <sup>6</sup> [lb./in.]	
Dynamic Load [lb]	960
Static Load [lb]	5565