

## PowerTrac 0631 - 0200 SRT LA, with SBN Ball Nut, Single Circuit

Call 800-321-7800 or visit us online at [www.nookindustries.com](http://www.nookindustries.com) to configure and order your PowerTrac 0631 - 0200 SRT LA, with SBN Ball Nut, Single

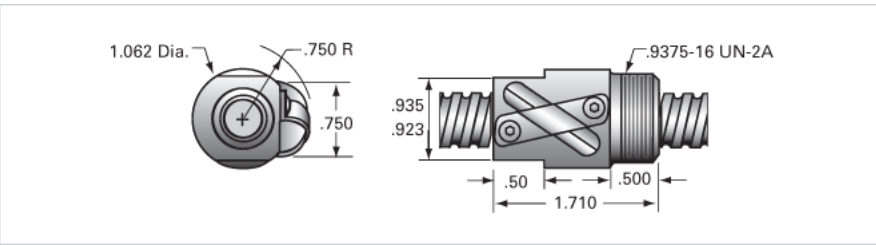

<b>Inch Ball Screw</b>	
<b>(Screw)Product Info</b>	
Screw Code	0631-0200 SRT LA
Precision	SRT
Screw Material	4150
Thread Direction	LH
<b>(Screw)Details</b>	
Ball Circle Diameter [in]	0.631
Lead [in]	0.200
Root Diameter [in]	0.500
End Code for Types 1,2,3,5 [* Journals may show tracings of the thread]	12
End Code for Type 4 [* Journals may show tracings of the thread]	8
<b>(Screw)Performance Specifications</b>	
Lead Accuracy +/- [in./ft.]	0.0040
<b>(Screw)Part Numbers</b>	
2 ft. Part Number	SRT9562
4 ft. Part Number	SRT5092
6 ft. Part Number	SRT7541
8 ft. Part Number	
12 ft. Part Number	
16 ft. Part Number	
20 ft. Part Number	
<b>(Screw)Weight</b>	
Screw Weight [lb./ft.]	0.82
<b>Inch Ball Nut, for SRT, Standard Accuracy, No Preload, SBN, Standard</b>	
<b>(Nut)Product Info</b>	
Ball Nut Number	SBN10409
Thread Direction	LH
<b>(Nut)Details</b>	
Ball Circle Diameter [in]	0.631
Lead [in]	0.200
Nominal Ball Diameter [in]	0.125
Root diameter [in]	0.500
<b>(Nut)Dimensions</b>	
A [in]	
<b>(Nut)Forces and Torques</b>	
Torque to Raise 1 lb. [in-lb]	0.035
<b>(Nut)Flange Part Numbers</b>	
Flange Part Number	FLG7570
<b>(Nut)Wiper Part Numbers</b>	
Wiper Kit Part Number	WKB10407
Wiper Kit Felt Part Number	
<b>(Nut)Weight</b>	
Nut Weight [lb]	0.27
<b>(Nut)Performance Specifications</b>	
Lead Accuracy +/- [in./ft.]	0.004
Maximum Adjustable Preload [lb]	
Spring Rate x 10 <sup>6</sup> [lb./in.]	
Dynamic Load [lb]	815
Static Load [lb]	6384