

## PowerTrac 0631 - 0200 SRT LA, with SBN Ball Nut, Internal Return

Call 800-321-7800 or visit us online at [www.nookindustries.com](http://www.nookindustries.com) to configure and order your PowerTrac 0631 - 0200 SRT LA, with SBN Ball Nut, Internal

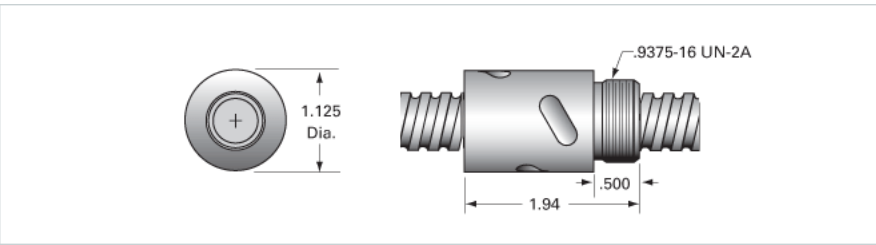

|                                                                             |                  |
|-----------------------------------------------------------------------------|------------------|
| <b>Inch Ball Screw</b>                                                      |                  |
| <b>(Screw)Product Info</b>                                                  |                  |
| Screw Code                                                                  | 0631-0200 SRT LA |
| Precision                                                                   | SRT              |
| Screw Material                                                              | 4150             |
| Thread Direction                                                            | LH               |
| <b>(Screw)Details</b>                                                       |                  |
| Ball Circle Diameter [in]                                                   | 0.631            |
| Lead [in]                                                                   | 0.200            |
| Root Diameter [in]                                                          | 0.500            |
| End Code for Types 1,2,3,5 [* Journals may show tracings of the thread]     | 12               |
| End Code for Type 4 [* Journals may show tracings of the thread]            | 8                |
| <b>(Screw)Performance Specifications</b>                                    |                  |
| Lead Accuracy +/- [in./ft.]                                                 | 0.0040           |
| <b>(Screw)Part Numbers</b>                                                  |                  |
| 2 ft. Part Number                                                           | SRT9562          |
| 4 ft. Part Number                                                           | SRT5092          |
| 6 ft. Part Number                                                           | SRT7541          |
| 8 ft. Part Number                                                           |                  |
| 12 ft. Part Number                                                          |                  |
| 16 ft. Part Number                                                          |                  |
| 20 ft. Part Number                                                          |                  |
| <b>(Screw)Weight</b>                                                        |                  |
| Screw Weight [lb./ft.]                                                      | 0.82             |
| <b>Inch Ball Nut, for SRT, Standard Accuracy, No Preload, SBN, Standard</b> |                  |
| <b>(Nut)Product Info</b>                                                    |                  |
| Ball Nut Number                                                             | SBN10264         |
| Thread Direction                                                            | LH               |
| <b>(Nut)Details</b>                                                         |                  |
| Ball Circle Diameter [in]                                                   | 0.631            |
| Lead [in]                                                                   | 0.200            |
| Nominal Ball Diameter [in]                                                  | 0.125            |
| Root diameter [in]                                                          | 0.500            |
| <b>(Nut)Dimensions</b>                                                      |                  |
| A [in]                                                                      |                  |
| <b>(Nut)Forces and Torques</b>                                              |                  |
| Torque to Raise 1 lb. [in-lb]                                               | 0.035            |
| <b>(Nut)Flange Part Numbers</b>                                             |                  |
| Flange Part Number                                                          | FLG7570          |
| <b>(Nut)Wiper Part Numbers</b>                                              |                  |
| Wiper Kit Part Number                                                       | WKB10407         |
| Wiper Kit Felt Part Number                                                  |                  |
| <b>(Nut)Weight</b>                                                          |                  |
| Nut Weight [lb]                                                             | 0.27             |
| <b>(Nut)Performance Specifications</b>                                      |                  |
| Lead Accuracy +/- [in./ft.]                                                 | 0.004            |
| Maximum Adjustable Preload [lb]                                             |                  |
| Spring Rate x 10 <sup>6</sup> [lb./in.]                                     |                  |
| Dynamic Load [lb]                                                           | 712              |
| Static Load [lb]                                                            | 5250             |