

## Type 2L, End Code 75

Call 800-321-7800 or visit us online at [www.nookindustries.com](http://www.nookindustries.com) to configure and order your Type 2L, End Code 75 today!

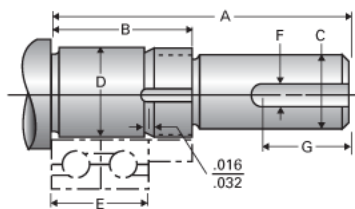

### Product Info

Nominal Bearing Journal Size

75

### Dimensions

C Maximum [in]	2.750
C Minimum [in]	2.749
D Maximum [in]	2.9533
D Minimum [in]	2.9527
F [in]	N/A
G [in]	N/A
Typical Journal for Single Bearing A [in]	9.14
Typical Journal for Single Bearing B [in]	3.64
Typical Journal for Single Bearing E [in]	2.914
Lock Nut	AN-15
Lock Washer	W-15