

## Type 2L, End Code 45

Call 800-321-7800 or visit us online at [www.nookindustries.com](http://www.nookindustries.com) to configure and order your Type 2L, End Code 45 today!

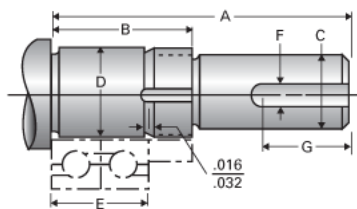

### Product Info

Nominal Bearing Journal Size

45

### Dimensions

C Maximum [in]	1.375
C Minimum [in]	1.374
D Maximum [in]	1.7721
D Minimum [in]	1.7716
F [in]	N/A
G [in]	N/A
Typical Journal for Single Bearing A [in]	4.71
Typical Journal for Single Bearing B [in]	2.52
Typical Journal for Single Bearing E [in]	1.968
Lock Nut	N-09
Lock Washer	W-09