

Type 2L, End Code 40

Call 800-321-7800 or visit us online at www.nookindustries.com to configure and order your Type 2L, End Code 40 today!

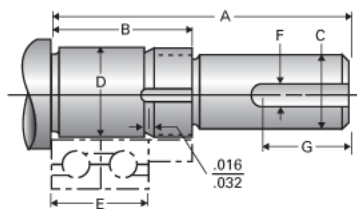

Product Info

Nominal Bearing Journal Size	40
------------------------------	----

Dimensions

C Maximum [in]	1.375
C Minimum [in]	1.374
D Maximum [in]	1.5752
D Minimum [in]	1.5747
F [in]	N/A
G [in]	N/A
Typical Journal for Single Bearing A [in]	4.55
Typical Journal for Single Bearing B [in]	2.37
Typical Journal for Single Bearing E [in]	1.812
Lock Nut	N-08
Lock Washer	W-08