

**PowerTrac SEL 0375 - 0125 RH, Adjustable Preloaded**

Call 800-321-7800 or visit us online at [www.nookindustries.com](http://www.nookindustries.com) to configure and order your PowerTrac SEL 0375 - 0125 RH, Adjustable Preloaded

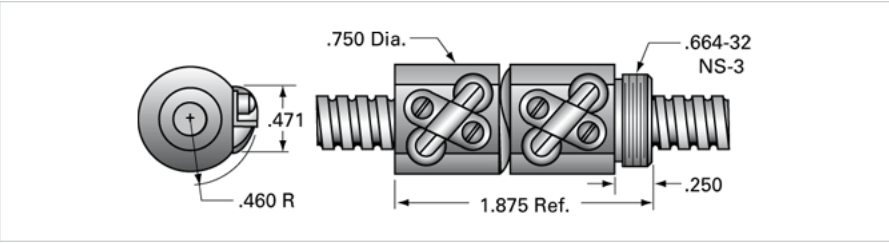

<b>Product Info</b>	
Ball Nut Number	SEL0375
Thread Direction	RH
<b>Details</b>	
Ball Circle Diameter [in]	0.375
Lead [in]	0.125
Nominal Ball Diameter [in]	0.063
Root diameter [in]	0.300
<b>Forces and Torques</b>	
Torque to Raise 1 lb. [in-lb]	0.022
<b>Flange Part Numbers</b>	
Flange Part Number	FLG6751
<b>Wiper Part Numbers</b>	
Wiper Kit Part Number	-
<b>Weight</b>	
Nut Weight [lb]	0.21
<b>Performance Specifications</b>	
Lead Accuracy +/- [in./ft.]	0.004
Maximum Adjustable Preload [lb]	10
Spring Rate x 10 <sup>6</sup> [lb./in.]	
Dynamic Load [lb]	136
Static Load [lb]	1415