

## PowerTrac PRN 1250 - 0500 RH, Preloaded

Call 800-321-7800 or visit us online at [www.nookindustries.com](http://www.nookindustries.com) to configure and order your PowerTrac PRN 1250 - 0500 RH, Preloaded today!

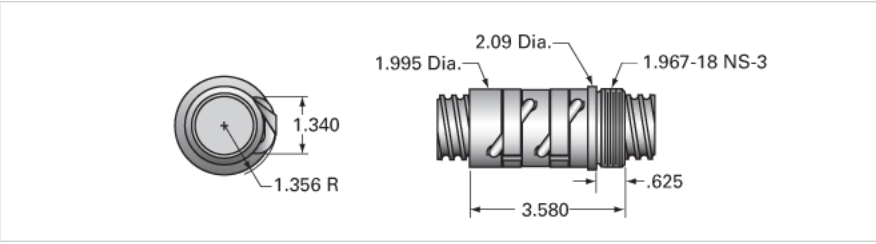

Product Info	
Ball Nut Number	PRN10087
Thread Direction	RH
Details	
Ball Circle Diameter [in]	1.250
Lead [in]	0.500
Nominal Ball Diameter [in]	0.188
Root diameter [in]	1.050
Forces and Torques	
Torque to Raise 1 lb. [in-lb]	0.088
Flange Part Numbers	
Flange Part Number	FLG7572
Wiper Part Numbers	
Wiper Kit Part Number	ELASTOMER
Weight	
Nut Weight [lb]	2.75
Performance Specifications	
Maximum Adjustable Preload [lb]	
Spring Rate x 10 <sup>6</sup> [lb./in.]	4.25
Dynamic Load [lb]	1765
Static Load [lb]	11080