

## DLT 160

Call 800-321-7800 or visit us online at [www.nookindustries.com](http://www.nookindustries.com) to configure and order your DLT 160 today!

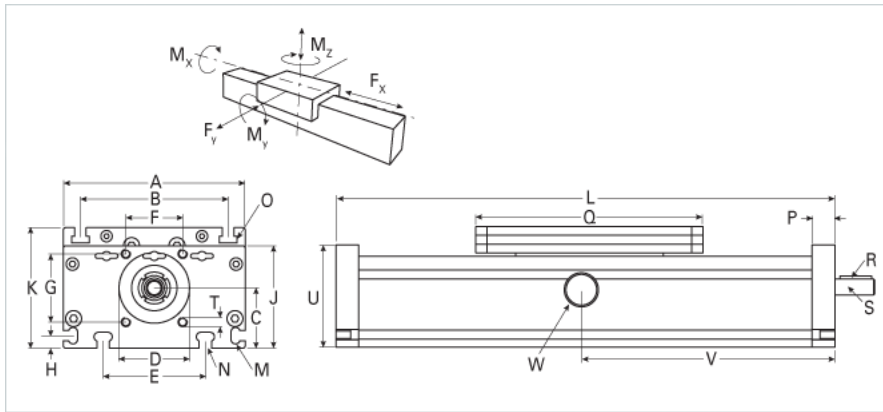

| Details  |             |
|--|-------------|
| Size   | 160         |
| Screw Options                                      | 24x5/24x10  |
| Screw Type   | Trapexoidal |
| Dimensions   |             |
| Basic Length L [mm]                                | 260         |
| A [mm]   | 160         |
| B [mm]   | 130         |
| C [mm]   | 53          |
| D [mm]   | 62          |
| E [mm]   | 90          |
| F [mm]   | 50          |
| H [mm]   | 11          |
| J [mm]   | 90          |
| K [mm]   | 106         |
| M  | M 6         |
| N  | M 8         |
| O  | M 8         |
| P [mm]   | 20          |
| Q [mm]   | 200         |
| Shaft R Key [mm]                                   | 5x5x28      |
| Shaft S Diameter x Length [mm]                     | 14 h6 x 35  |
| T  | M 8         |
| Forces and Torques                                 |             |
| No Load Torque-Dynamic                             | 0.9         |
| Fx dynamic [N]                                     | 4000        |
| Fy dynamic [N]                                     | 2000        |
| Fz dynamic [N]                                     | 2800        |
| Mx dynamic [Nm]                                    | 320         |
| My dynamic [Nm]                                    | 300         |
| Mz dynamic [Nm]                                    | 150         |
| Fx static [N]                                      | 5000        |
| Fy static [N]                                      | 3000        |
| Fz static [N]                                      | 3500        |
| Mx static [Nm]                                     | 400         |
| My static [Nm]                                     | 360         |
| Mz static [Nm]                                     | 180         |
| Geometrical moments of inertia of aluminum profile |             |
| Elastic modulus [N/mm <sup>2</sup> ]               | 70000       |
| Ix [mm <sup>4</sup> ]                              | 2220000     |
| Iy [mm <sup>4</sup> ]                              | 12200000    |
| Weight   |             |
| Additional Weight per 100 mm [kg]                  | 1.96        |
| Basic Weight [kg]                                  | 8.2         |