

PowerTrac 1500 - 0473 SRT RA, with SBN Ball Nut, Double Circuit

Call 800-321-7800 or visit us online at www.nookindustries.com to configure and order your PowerTrac 1500 - 0473 SRT RA, with SBN Ball Nut, Double

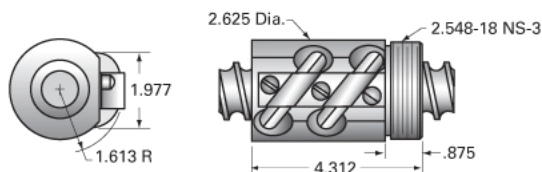

Inch Ball Screw

(Screw)Product Info

| | |
|------------------|------------------|
| Screw Code | 1500-0473 SRT RA |
| Precision | SRT |
| Screw Material | 4150 |
| Thread Direction | RH |

(Screw)Details

| | |
|---|-------|
| Ball Circle Diameter [in] | 1.500 |
| Lead [in] | 0.473 |
| Root Diameter [in] | 1.140 |
| End Code for Types 1,2,3,5 [* Journals may show tracings of the thread] | 25 |
| End Code for Type 4 [* Journals may show tracings of the thread] | 16 |

(Screw)Performance Specifications

| | |
|-----------------------------|--------|
| Lead Accuracy +/- [in./ft.] | 0.0040 |
|-----------------------------|--------|

(Screw)Part Numbers

| | |
|--------------------|---------|
| 2 ft. Part Number | |
| 4 ft. Part Number | SRT9610 |
| 6 ft. Part Number | |
| 8 ft. Part Number | SRT9127 |
| 12 ft. Part Number | SRT9624 |
| 16 ft. Part Number | SRT0435 |
| 20 ft. Part Number | SRT0597 |

(Screw)Weight

| | |
|------------------------|------|
| Screw Weight [lb./ft.] | 4.47 |
|------------------------|------|

Inch Ball Nut, for SRT, Standard Accuracy, No Preload, SBN, Standard

(Nut)Product Info

| | |
|------------------|---------|
| Ball Nut Number | SBN7513 |
| Thread Direction | RH |

(Nut)Details

| | |
|----------------------------|-------|
| Ball Circle Diameter [in] | 1.500 |
| Lead [in] | 0.473 |
| Nominal Ball Diameter [in] | 0.344 |
| Root diameter [in] | 1.140 |

(Nut)Dimensions

A [in]

(Nut)Forces and Torques

| | |
|-------------------------------|-------|
| Torque to Raise 1 lb. [in-lb] | 0.084 |
|-------------------------------|-------|

(Nut)Flange Part Numbers

| | |
|--------------------|---------|
| Flange Part Number | FLG7573 |
|--------------------|---------|

(Nut)Wiper Part Numbers

| | |
|----------------------------|---------|
| Wiper Kit Part Number | WKB2655 |
| Wiper Kit Felt Part Number | |

(Nut)Weight

| | |
|-----------------|------|
| Nut Weight [lb] | 3.90 |
|-----------------|------|

(Nut)Performance Specifications

| | |
|--|-------|
| Lead Accuracy +/- [in./ft.] | 0.004 |
| Maximum Adjustable Preload [lb] | |
| Spring Rate x 10⁶ [lb./in.] | |
| Dynamic Load [lb] | 10050 |
| Static Load [lb] | 57770 |