

Type 2L, End Code 45

Call 800-321-7800 or visit us online at www.nookindustries.com to configure and order your Type 2L, End Code 45 today!

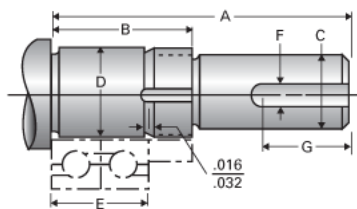

Product Info

| | |
|------------------------------|----|
| Nominal Bearing Journal Size | 45 |
|------------------------------|----|

Dimensions

| | |
|---|--------|
| C Maximum [in] | 1.375 |
| C Minimum [in] | 1.374 |
| D Maximum [in] | 1.7721 |
| D Minimum [in] | 1.7716 |
| F [in] | N/A |
| G [in] | N/A |
| Typical Journal for Single Bearing A [in] | 4.71 |
| Typical Journal for Single Bearing B [in] | 2.52 |
| Typical Journal for Single Bearing E [in] | 1.968 |
| Lock Nut | N-09 |
| Lock Washer | W-09 |