

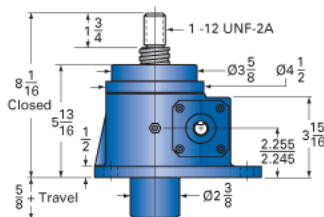

Call 800-321-7800 or visit us online at www.nookindustries.com to configure and order your ActionJac 5-MSJ-UK 24:1 today!

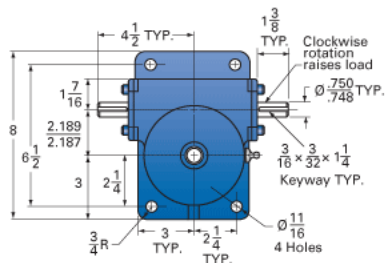

Top Plate (optional): 9000-00-02

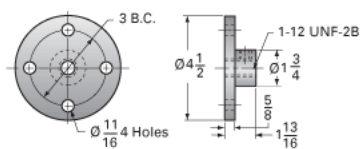

Clevis End (optional): 9001-00-02

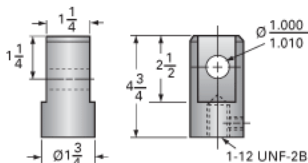

Capacity [Ton]

Gear Ratio	24:1
Turns of Worm per Inch Travel	64
Torque to Raise 1 lb. [in-lb]	0.0166
Lifting Screw Diameter [in]	1.50
Screw Lead [in]	0.375
Root Diameter [in]	1.066
Tare Drag Torque [in-lb]	10

Maximum Allowable Input [hp]

Maximum Allowable Input [hp]	0.75
Maximum Input Torque [in-lb]	144
Maximum Worm Speed at Rated Load [rpm]	287
Maximum Load at 1750 RPM [lb]	1627
Starting Torque	2 x Running Torque

Base 0 Travel [lb]

Per Inch of Travel [lb]	0.70
Grease [lb]	1.0