

METRIC TRAPEZOIDAL SCREW JACKS TECHNICAL DATA

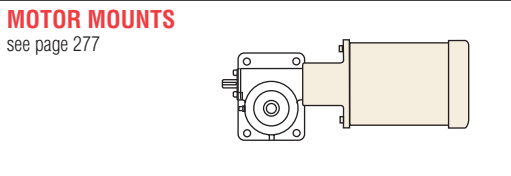

**ACME NUT & FLANGE DIMENSIONS**

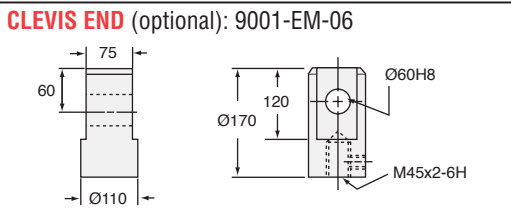
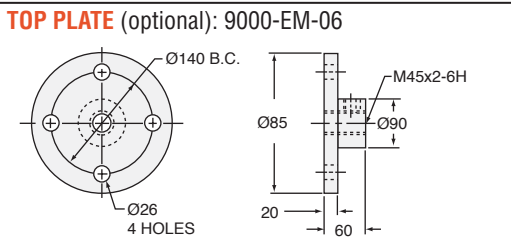
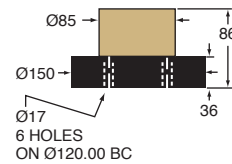

**EM20-MSJ SCREW**

SCREW: Tr65x12  
 ROOT DIAMETER: 50  
 DRAG TORQUE: 4.52  
 START TORQUE: 2 x Running Torque  
 WEIGHT (Approx. in Kg)  
 "0" TRAVEL: 36.3  
 PER 100mm TRAVEL: 2.12  
 GREASE: 1.0

RATIO	TRAVEL PER 1 TURN OF WORM	TORQUE TO RAISE ONE kN NON-KEYED	MAX. KW	MAX. WORM SPEED AT RATED LOAD NON-KEYED	MAX. LOAD AT 1425 RPM NON-KEYED
8:1	1.50 mm	1.08 Nm	5.6	250 rpm	35.0 kN
24:1	0.5 mm	0.54 Nm	1.9	165 rpm	23.0 kN

LIFTING SCREW OR NUT MUST BE SECURED TO PREVENT ROTATION FOR NON-KEYED UNITS.  
**CAUTION!** JACK MAY BE SELF-LOWERING IN SOME OPERATING CONDITIONS.