

FOR ORDERING
SPECIFY "L"
DIMENSION
L (min) =
TRAVEL + 227

FOR ORDERING
SPECIFY "L"
DIMENSION
L (min) =
TRAVEL + 120

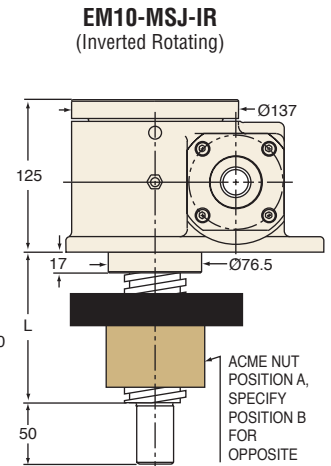

TOP PLATE (optional): 9000-EM-04

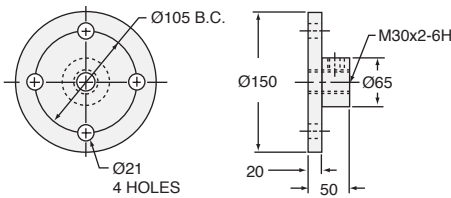

CLEVIS END (optional): 9001-EM-04

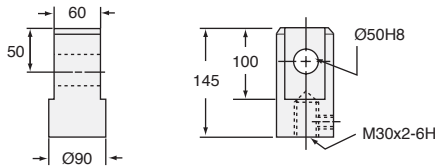

MOTOR MOUNTS

see page 277

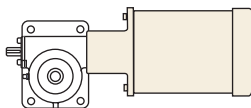

ACME NUT & FLANGE DIMENSIONS

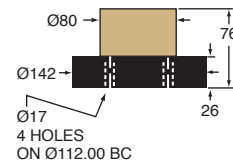

EM10-MSJ SCREW

SCREW: Tr55x12
ROOT DIAMETER: 40
DRAG TORQUE: 2.26
START TORQUE: 2 x Running Torque
WEIGHT (Approx. in Kg)
"0" TRAVEL: 20.4
PER 100mm TRAVEL: 1.46
GREASE: 0.68

| RATIO | TRAVEL PER 1 TURN OF WORM | TORQUE TO RAISE ONE kN NON-KEYED | MAX. kW | MAX. WORM SPEED AT RATED LOAD NON-KEYED | MAX. LOAD AT 1425 RPM NON-KEYED |
|-------|---------------------------|----------------------------------|---------|---|---------------------------------|
| 8:1 | 1.5 mm | 0.97 Nm | 3.65 | 360 rpm | 25.2 kN |
| 24:1 | 0.5 mm | 0.50 Nm | 1.10 | 210 rpm | 14.8 kN |

LIFTING SCREW OR NUT MUST BE SECURED TO PREVENT ROTATION FOR NON-KEYED UNITS.
CAUTION! JACK MAY BE SELF-LOWERING IN SOME OPERATING CONDITIONS.