

**FOR ORDERING**  
SPECIFY "L"  
DIMENSION  
L (min) =  
TRAVEL + 168

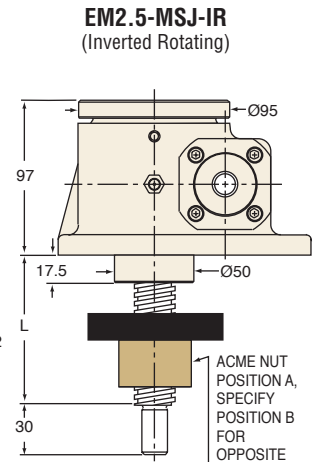

**FOR ORDERING**  
SPECIFY "L"  
DIMENSION  
L (min) =  
TRAVEL + 92

**TOP PLATE (optional): 9000-EM-01**

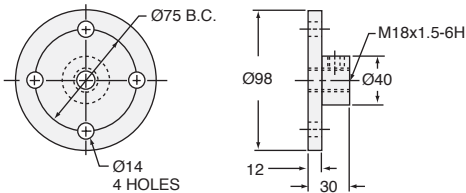

**CLEVIS END (optional): 9001-EM-01**

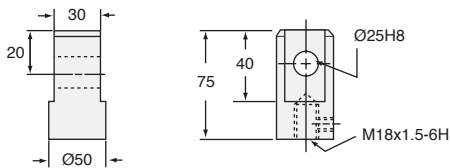

**MOTOR MOUNTS**

see page 277

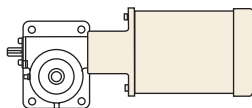

**ACME NUT & FLANGE DIMENSIONS**

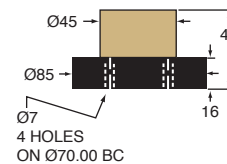

**EM2.5-MSJ SCREW**

**SCREW:** Tr26x6  
**ROOT DIAMETER:** 17.8  
**DRAG TORQUE:** .56  
**START TORQUE:** 2 x Running Torque  
**WEIGHT (Approx. in Kg)**  
**"0" TRAVEL:** 7.7  
**PER 100mm TRAVEL:** 0.32  
**GREASE:** 0.22

RATIO	TRAVEL PER 1 TURN OF WORM	TORQUE TO RAISE ONE kN NON-KEYED	MAX. kW	MAX. WORM SPEED AT RATED LOAD NON-KEYED	MAX. LOAD AT 1425 RPM NON-KEYED
6:1	1.0 mm	0.59 Nm	1.51	975 rpm	17.0 kN
12:1	0.5 mm	0.35 Nm	1.13	1235 rpm	21.7 kN
24:1	0.25 mm	0.25 Nm	0.38	575 rpm	10.1 kN

LIFTING SCREW OR NUT MUST BE SECURED TO PREVENT ROTATION FOR NON-KEYED UNITS.  
**CAUTION!** JACK MAY BE SELF-LOWERING IN SOME OPERATING CONDITIONS.