

FOR ORDERING
SPECIFY "L"
DIMENSION
L (min) =
TRAVEL + 125

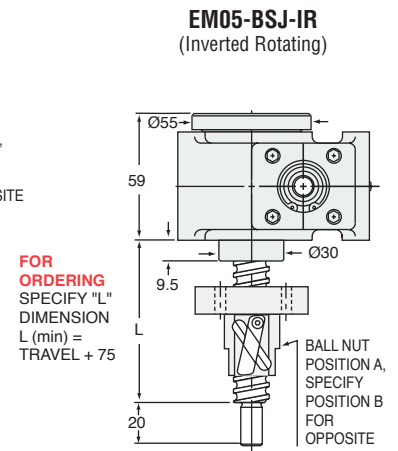

FOR ORDERING
SPECIFY "L"
DIMENSION
L (min) =
TRAVEL + 75

TOP PLATE (optional): 9000-EM-12

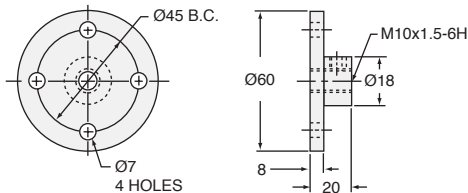

CLEVIS END (optional): 9001-EM-12

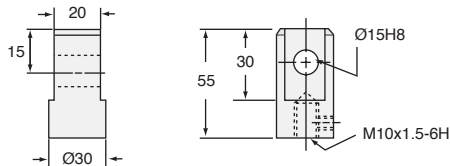

MOTOR MOUNTS

see page 277

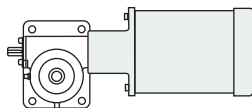

BALL NUT & FLANGE DIMENSIONS

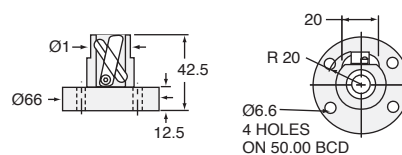

EM05-BSJ SCREW

SCREW: MRT16x5
ROOT DIAMETER: 12.9
DRAG TORQUE: .11
START TORQUE: 2 x Running Torque
WEIGHT (Approx. in Kg)
"0" TRAVEL: 1.36
PER 100mm TRAVEL: 0.14
GREASE: 0.14

RATIO	TRAVEL PER 1 TURN OF WORM	TORQUE TO RAISE ONE kN NON-KEYED	MAX. kW	MAX. WORM SPEED AT RATED LOAD NON-KEYED	MAX. LOAD AT 1425 RPM NON-KEYED
5:1	1.00 mm	0.24 Nm	0.21	1625 rpm	5.0 kN
20:1	0.25 mm	0.10 Nm	0.09	1625 rpm	5.0 kN

CAUTION! JACK IS SELF-LOWERING. LIFTING SCREW OR NUT MUST BE SECURED TO PREVENT ROTATION FOR NON-KEYED UNITS.