

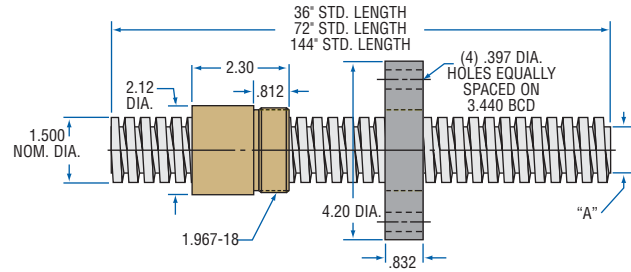

1-1/2" ACME THREAD

LEAD ACCURACY: ±0.0003 in./in.

LOAD CAPACITY (lbs.)	DYNAMIC	STATIC
BRONZE NUT	11,250	36,000
PLASTIC NUT	5,625	5,625



INCH ACME SCREW AND NUT TECHNICAL DATA

PRODUCT SPECIFICATIONS		SCREW SIZE					
		1 1/2"-2	1 1/2"-2 2/3	1 1/2"-4	1 1/2"-5	1 1/2"-10	
Lead		.500	.375	.250	.200	.100	
Pitch		.250	.375	.250	.200	.100	
Starts		2	1	1	1	1	
Threads Per Inch		4	2 2/3	4	5	10	
Lash (Maximum Axial)		.012	.010	.010	.010	.009	
"A" – Root Diameter (min.)		1.196	1.066	1.196	1.249	1.355	
Weight (lbs./ft.)		4.95	4.55	4.99	4.90	5.47	
Thread Code		152	153	154	155	150	
Form		2C	40°	2C	2C	2C	
36" Standard Length Part No. *	RH	4140	11152	11153	11154	11155	11150
		Stainless	—	91153	91154	91155	—
	LH	4140	51152	51153	51154	51155	51150
		Stainless	—	—	94154	94155	—
72" Standard Length Part No. *	RH	4140	12152	12153	12154	12155	12150
		Stainless	—	92153	92154	92155	—
	LH	4140	52152	52153	52154	52155	52150
		Stainless	—	—	95154	95155	—
144" Standard Length Part No. *	RH	4140	13152	13153	13154	13155	13150
		Stainless	—	93153	93154	93155	—
	LH	4140	53152	53153	53154	53155	53150
		Stainless	—	—	96154	96155	—

* Custom Lengths Available - See page 15 to specify length

BRONZ/AC BRONZE NUT		1 1/2"-2	1 1/2"-2 2/3	1 1/2"-4	1 1/2"-5	1 1/2"-10
Efficiency		46%	40%	30%	25%	15%
Torque to Raise 1 lb. (in.-lb.)		.173	.149	.133	.127	.110
Weight (lbs.)		1.38	1.49	1.53	1.35	1.28
Part No.	RH	20152	20153	20154	20155	20150
	LH	80152	80153	80154	80155	80150

PLAST/AC PLASTIC NUT		1 1/2"-2	1 1/2"-2 2/3	1 1/2"-4	1 1/2"-5	1 1/2"-10
Efficiency		52%	46%	36%	30%	17%
Torque to Raise 1 lb. (in.-lb.)		.152	.129	.111	.105	.091
Weight (lbs.)		.20	.22	.22	.20	.19
Part No.	RH	30152	30153	30154	30155	30150
	LH	40152	40153	40154	40155	40150

FLANGE - STEEL		1 1/2"-2	1 1/2"-2 2/3	1 1/2"-4	1 1/2"-5	1 1/2"-10
Weight (lbs.)		3.19	3.19	3.19	3.19	3.19
Standard Part No.		70420	70420	70420	70420	70420
No-Lash™ Part No.		73420	73420	73420	73420	73420

ACME SCREW ASSEMBLIES

These assemblies are shipped with screw, nut, flange, and bearing supports.

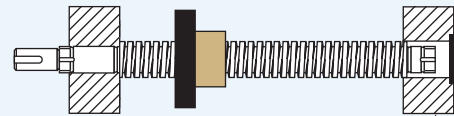

See page 41 for complete product details.

EZZE-MOUNT™ END BEARING SUPPORTS

A convenient solution for mounting acme screw assemblies.

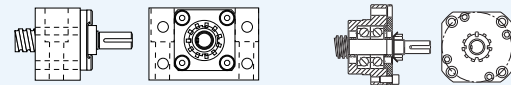

Single or Double Bearing Universal Mount

Single or Double Bearing Flange Mount

EZZE-MOUNT™ available for: All 1-1/2" Screws
See page 214 for complete product details.

TWIN-LEAD SCREW

Single piece twin-lead screws offer opposing motion through a single drive system.

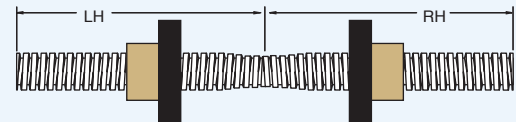

Twin-Lead Screw available for: All 1-1/2" Screws
See page 44 for complete product details.

LUBRICANT

Prolong acme screw and nut performance with these special lubricants.



E-100 12 Oz. Acme Screw Spray Lubricant



PAG-1 1 lb. Acme Screw Grease

See page 14 for complete product details.