

0631-0200 XPR and SGT

LEAD ACCURACY: XPR ±0.001 in./ft. SGT ±0.0005 in./ft.

Single Start

- 0.631** Ball Circle Diameter
- 0.200** Lead
- 0.500** Root Diameter
- 0.125** Nominal Ball Diameter
- 0.86** Screw Weight (lbs./ft.)

Standard Screw Lengths	PART NUMBERS		
	XPR RH	SGT RH	SGT LH
4 FT.	XPR6320R48	GT06320R48	GT06320L48
6 FT.	XPR6320R72	—	—

XPR custom cut lengths available up to 12',
SGT custom cut lengths available up to 6', contact Customer Service.

INCH BALL SCREW AND NUT TECHNICAL DATA

PRN Preloaded Ball Nut with Wipers

30 bearing balls per circuit - 60 total per nut

PRODUCT SPECIFICATIONS	RH
Dynamic Load (lbs.)	440
Static Load (lbs.)	2,110
Torque to Raise 1 lb. (in.-lb.)	.035
Spring Rate x 10 ⁶ (lb./in.)	1.6
Nut Weight (lbs.)	.98
Ball Nut Number	PRN10108
Flange Part Number	FLG7555
Wiper Type	ELASTOMER

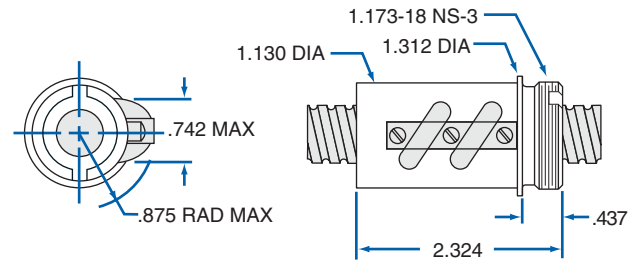

SGN Ball Nut

30 bearing balls per circuit - 60 total per nut

PRODUCT SPECIFICATIONS	RH	LH
Dynamic Load (lbs.)	700	700
Static Load (lbs.)	3,360	3,360
Torque to Raise 1 lb. (in.-lb.)	.035	.035
Nut Weight (lbs.)	.80	.80
Ball Nut Number	SGN10083	SGN10253
Flange Part Number	FLG7570	FLG7570
Wiper Kit Part Number	—	—

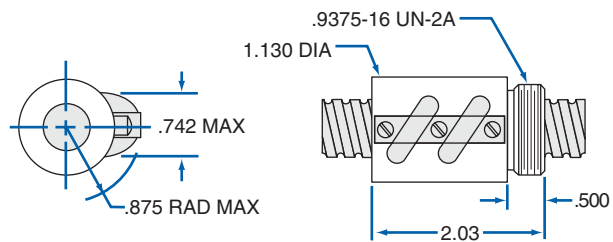

PRN Preloaded Ball Nut

30 bearing balls per circuit - 60 total per nut

PRODUCT SPECIFICATIONS	RH
Dynamic Load (lbs.)	350
Static Load (lbs.)	1,680
Torque to Raise 1 lb. (in.-lb.)	.035
Spring Rate x 10 ⁶ (lb./in.)	1.0
Nut Weight (lbs.)	.80
Ball Nut Number	PRN10106
Flange Part Number	FLG7570
Wiper Kit Part Number	—

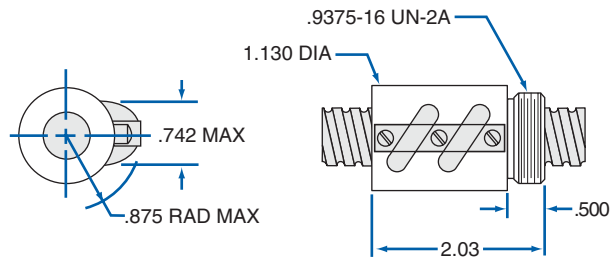

SSN Preloaded Flanged Ball Nut with Wipers

30 bearing balls per circuit - 60 total per nut

PRODUCT SPECIFICATIONS	RH
Dynamic Load (lbs.)	440
Static Load (lbs.)	2,110
Torque to Raise 1 lb. (in.-lb.)	.035
Spring Rate x 10 ⁶ (lb./in.)	1.6
Nut Weight (lbs.)	1.2
Ball Nut Number	SSN0389
Flange	INTEGRAL
Wiper Type	ELASTOMER

