

# 0631-0200 SRT

**LEAD ACCURACY:** ±0.004 in./ft.

Single Start

- 0.631** Ball Circle Diameter
- 0.200** Lead
- 0.500** Root Diameter
- 0.125** Nominal Ball Diameter
- 0.82** Screw Weight (lbs./ft.)

Standard Screw Lengths	PART NUMBERS		
	RH	LH	RHSS
<b>2 FT.</b>	SRT9392	SRT9562	SRT5359
<b>4 FT.</b>	SRT9987	SRT5092	SRT5648
<b>6 FT.</b>	SRT7540	SRT7541	SRT5378

Custom cut lengths available up to 24' for alloy, up to 12' for stainless.  
For longer lengths contact Customer Service.

INCH BALL SCREW AND NUT TECHNICAL DATA

## SBN Single Circuit Ball Nut

68 bearing balls total per nut

PRODUCT SPECIFICATIONS	RH	LH	RHSS
<b>Dynamic Load (lbs.)</b>	—	—	140
<b>Static Load (lbs.)</b>	—	—	1,149
<b>Torque to Raise 1 lb. (in.-lb.)</b>	—	—	.035
<b>Nut Weight (lbs.)</b>	—	—	.27
<b>Ball Nut Number</b>	—	—	SBN7645
<b>Flange Part Number</b>	—	—	—
<b>Wiper Kit Part Number</b>	—	—	—

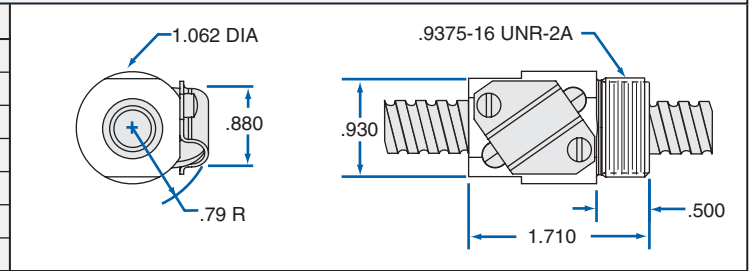

## SBN Single Circuit Ball Nut with Wrench Flats

68 bearing balls total per nut

PRODUCT SPECIFICATIONS	RH	LH	RHSS
<b>Dynamic Load (lbs.)</b>	815	815	—
<b>Static Load (lbs.)</b>	6,384	6,384	—
<b>Torque to Raise 1 lb. (in.-lb.)</b>	.035	.035	—
<b>Nut Weight (lbs.)</b>	.27	.27	—
<b>Ball Nut Number</b>	SBN10325	SBN10409	—
<b>Flange Part Number</b>	FLG7570	FLG7570	—
<b>Wiper Kit Part Number</b>	WKB10407	WKB10407	—

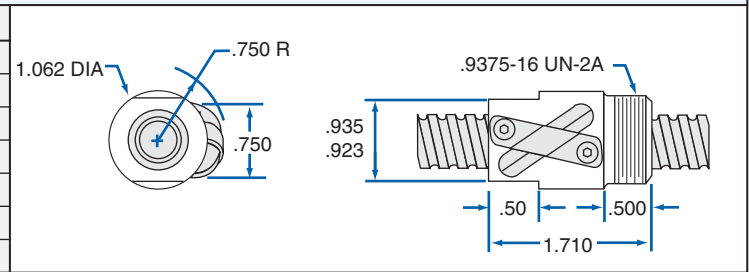

### Flange - FLG7570

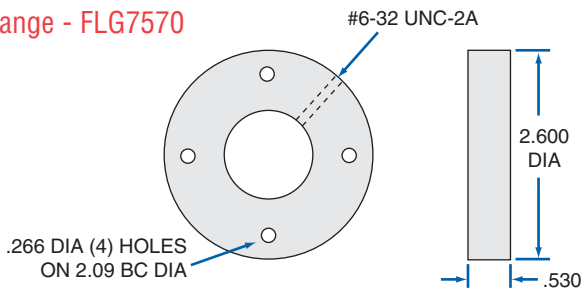

### Brush Wiper Kit - WKB10407

2 wipers and 1 retainer

