

MBN 6x1.25 RS Cylindrical Keyed

Call 800-321-7800 or visit us online at www.nookindustries.com to configure and order your MBN 6x1.25 RS Cylindrical Keyed today!

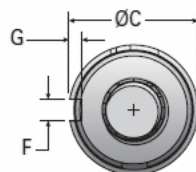
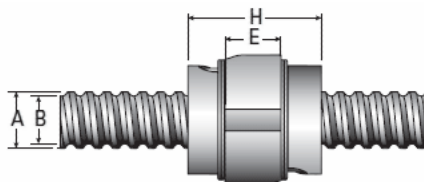

Product Info

Nominal Rod Diameter [mm]	6.20
Material	SS
Thread Direction	RH

Details

Lead [mm]	1.25
Active Turns	2
Nominal Ball Dia. [mm]	0.800
Ball Nut Number	MBN10727
Nut Weight [g]	9.5
Screw Weight [g/m]	215
End Code for Types 1,2, and 3	5
End Code for Types 4	2
End Code for Types 6	-
End Code for Types 7	-

Performance Specifications

Dynamic Load Ca [N]	258
Static Load [N]	253
Linear Speed (Based on DN Values) [mm/min]	14600

Forces and Torques

Torque to Raise 1 kN [N·m]	0.221
----------------------------	-------

Screw Dimensions

A [mm]	6.20
B [mm]	5.6

Nut Dimensions

C [mm]	13.0
H [mm]	17.2
E [mm]	8.6
F [mm]	2.0
G [mm]	1.20