

PowerTrac SBN 1500 - 0500 RH, Double Circuit, Safety Thread

Call 800-321-7800 or visit us online at www.nookindustries.com to configure and order your PowerTrac SBN 1500 - 0500 RH, Double Circuit, Safety

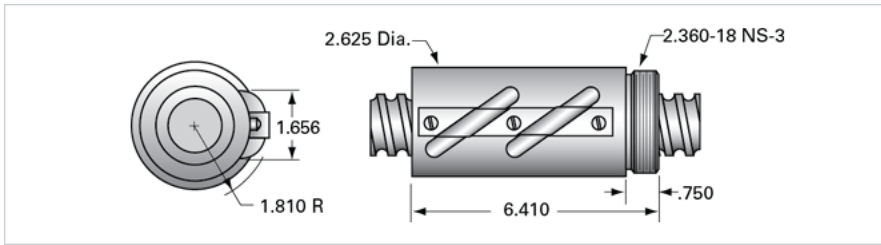

Product Info

| | |
|------------------|----------|
| Ball Nut Number | SBN10974 |
| Thread Direction | RH |

Details

| | |
|----------------------------|-------|
| Ball Circle Diameter [in] | 1.500 |
| Lead [in] | 0.500 |
| Nominal Ball Diameter [in] | 0.312 |
| Root diameter [in] | 1.174 |

Dimensions

A [in]

Forces and Torques

| | |
|-------------------------------|-------|
| Torque to Raise 1 lb. [in-lb] | 0.088 |
|-------------------------------|-------|

Flange Part Numbers

| | |
|--------------------|----------|
| Flange Part Number | FLG10060 |
|--------------------|----------|

Wiper Part Numbers

| | |
|----------------------------|-------|
| Wiper Kit Part Number | BRUSH |
| Wiper Kit Felt Part Number | |

Weight

| | |
|-----------------|------|
| Nut Weight [lb] | 5.20 |
|-----------------|------|

Performance Specifications

| | |
|---|-------|
| Lead Accuracy +/- [in./ft.] | 0.004 |
| Maximum Adjustable Preload [lb] | |
| Spring Rate x 10 ⁶ [lb./in.] | |
| Dynamic Load [lb] | 12320 |
| Static Load [lb] | 97696 |