

QSK 80 Dual Carriage Extended Carriage

Call 800-321-7800 or visit us online at www.nookindustries.com to configure and order your QSK 80 Dual Carriage Extended Carriage today!

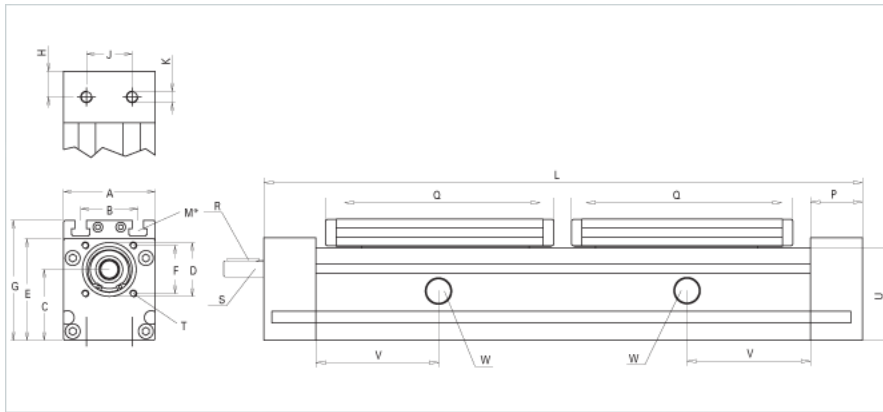

| Details | |
|---|------------------------|
| Size | 80 |
| Screw Options | 25x5/20x20/25x10/25x25 |
| Screw Type | Ball Screw |
| Dimensions | |
| Basic Length L with Divided Screw [mm] | 810 |
| Basic Length L with Twin Lead Screw [mm] | 770 |
| A [mm] | 80 |
| B [mm] | 50 |
| C [mm] | 62 |
| D [mm] | 47 |
| E [mm] | 89 |
| F [mm] | 42 |
| G [mm] | 106 |
| H [mm] | 22.5 |
| J [mm] | 40 |
| K | M10 |
| M | M8 |
| P [mm] | 45 |
| Q [mm] | 336 |
| Shaft R Key [mm] | 5x5x28 |
| Shaft S Diameter x Length [mm] | 14h6x35 |
| T | M6 |
| U [mm] | 80 |
| Forces and Torques | |
| Fx [N] 10000 km | 2000 |
| Fy [N] 10000 km | 2542 |
| Fz [N] 10000 km | 6050 |
| Mx [Nm] 10000 km | 76 |
| My [Nm] 10000 km | 430 |
| Mz [Nm] 10000 km | 392 |
| Fx [N] 5000 km | 2500 |
| Fy [N] 5000 km | 3570 |
| Fz [N] 5000 km | 8500 |
| Mx [Nm] 5000 km | 107 |
| My [Nm] 5000 km | 604 |
| Mz [Nm] 5000 km | 550 |
| Geometrical moments of inertia of aluminum profile | |
| Elastic modulus [N/mm ²] | 70000 |
| Ix [mm ⁴] | 1400000 |
| Iy [mm ⁴] | 1660000 |
| Weight | |
| Additional Weight per 100 mm [kg] | 0.9 |
| Basic Weight [kg] [.0} | 9.8 |