

PowerTrac SAG 2500 - 0250 RH

Call 800-321-7800 or visit us online at www.nookindustries.com to configure and order your PowerTrac SAG 2500 - 0250 RH today!

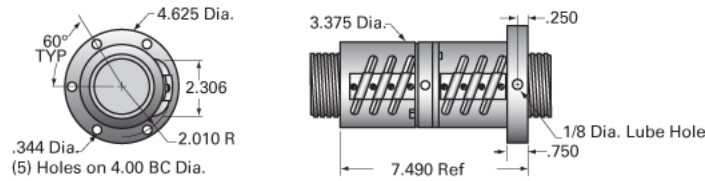

Product Info

Ball Nut Number	SAG0707
Thread Direction	RH

Details

Ball Circle Diameter [in]	2.500
Lead [in]	0.250
Nominal Ball Diameter [in]	0.156
Root diameter [in]	2.333

Forces and Torques

Torque to Raise 1 lb. [in-lb]	0.044
-------------------------------	-------

Flange Part Numbers

Flange Part Number	INTEGRAL
--------------------	----------

Wiper Part Numbers

Wiper Kit Part Number	BRUSH
-----------------------	-------

Weight

Nut Weight [lb]	9.90
-----------------	------

Performance Specifications

Maximum Adjustable Preload [lb]	1895
Spring Rate x 10 ⁶ [lb./in.]	
Dynamic Load [lb]	6315
Static Load [lb]	93165