

PowerTrac 1150 - 0200 XPR RA, with PRN Ball Nut, Preloaded

Call 800-321-7800 or visit us online at www.nookindustries.com to configure and order your PowerTrac 1150 - 0200 XPR RA, with PRN Ball Nut,

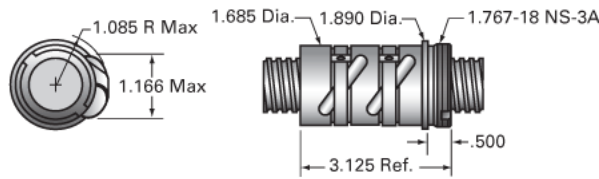

Inch Ball Screw

Product Info

Screw Code	1150-0200 XPR RA
Precision	XPR
Screw Material	4150
Thread Direction	RH

Details

Ball Circle Diameter [in]	1.150
Lead [in]	0.200
Root Diameter [in]	1.015
End Code for Types 1,2,3,5 [* Journals may show tracings of the thread]	25
End Code for Type 4 [* Journals may show tracings of the thread]	16

Performance Specifications

Lead Accuracy +/- [in./ft.]	0.0010
-----------------------------	--------

Part Numbers

2 ft. Part Number	
4 ft. Part Number	
6 ft. Part Number	XPR11520R72
8 ft. Part Number	
12 ft. Part Number	XPR11520R144
16 ft. Part Number	
20 ft. Part Number	

Weight

Screw Weight [lb./ft.]	3.18
------------------------	------

Inch Ball Nut, for SGT and XPR, Ground Accuracy, Preloaded, Fixed, PRN

Product Info

Ball Nut Number	PRN10112
Thread Direction	RH

Details

Ball Circle Diameter [in]	1.150
Lead [in]	0.200
Nominal Ball Diameter [in]	0.125
Root diameter [in]	1.015

Forces and Torques

Torque to Raise 1 lb. [in-lb]	0.035
-------------------------------	-------

Flange Part Numbers

Flange Part Number	FLG7576
--------------------	---------

Wiper Part Numbers

Wiper Kit Part Number	ELASTOMER
-----------------------	-----------

Weight

Nut Weight [lb]	1.45
-----------------	------

Performance Specifications

Maximum Adjustable Preload [lb]	
Spring Rate x 10 ⁶ [lb./in.]	4.25
Dynamic Load [lb]	1680
Static Load [lb]	14886