

## PowerAC 5/8"-5 TA w/Bronze Nut

Call 800-321-7800 or visit us online at [www.nookindustries.com](http://www.nookindustries.com) to configure and order your PowerAC 5/8"-5 TA w/Bronze Nut today!

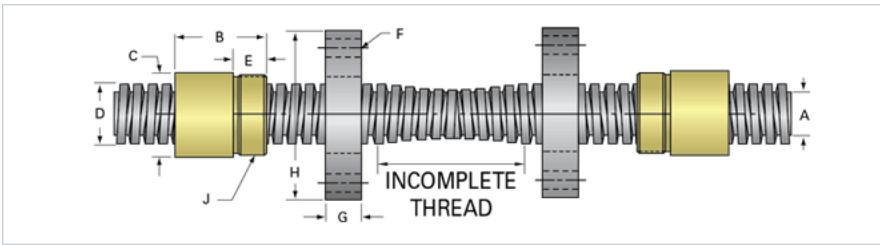
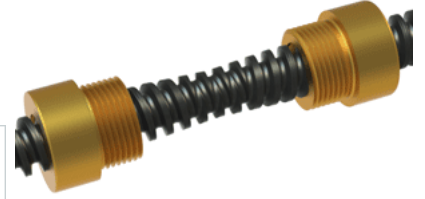

### Rolled Inch Twin-Lead Acme Screw

#### Product Info

Screw Code	065 TA
Screw Direction	RH/LH
Screw Material	4140 Series

#### Details

Lead [in]	0.200
Starts	1
Pitch [in]	0.200
Turns Per Inch	5
Threads per Inch	5
Thread Code	065
Form	2C
End Code for Types 1,2,3,5 [* Journals may show tracings of the thread]	9
End Code for Type 4 [* Journals may show tracings of the thread]	6

#### Dimensions

A - Root Diameter Minimum [in]	0.377
D - Nominal Rod Diameter [in]	0.625
Incomplete Overlapping Thread Length [in]	2.00
Maximum Overall Length [in]	36
Maximum Useable LH & RH Thread [in]	17.00

#### Weight

Weight Per Foot [lb]	0.84
----------------------	------

#### Part Numbers

36" Part Number	
72" Part Number	
144" Part Number	

#### Performance Specifications

Lead Accuracy +/- [in/in]	0.0003
---------------------------	--------

### Inch Acme Nut with Optional Flange

#### Product Info

Part Number	80065
Thread Direction	LH
Type	Bronze

#### Details

Lead [in]	0.200
Starts	1
Pitch [in]	0.200
Turns Per Inch	5
Lash (Maximum Axial) [in]	0.009
Nominal Rod Diameter [in]	0.625
Threads per Inch	5
Thread Code	065
Form	2C

#### Dimensions

B [in]	1.00
C [in]	1.13
E [in]	0.50
F (n) Dia. [in]	(4) .266
F BCD [in]	2.090
G [in]	0.53
H [in]	2.60
J [in]	.937-16

#### Forces and Torques

Torque to Raise 1 lb. [in-lb]	0.072
-------------------------------	-------

#### Flange Part Numbers

Flange No-Lash Part Number	
Flange Part Number	FLG7570

#### Weight

Flange Weight [lb]	0.77
--------------------	------

Nut Weight [lb]	0.23
<b>Performance Specifications</b>	
Efficiency [%]	44
Lead Accuracy +/- [in/in]	0.0003
Dynamic Load Capacity [lb]	1953
Static Load Capacity [lb]	6250
<b>Inch Acme Nut with Optional Flange</b>	
<b>Product Info</b>	
Part Number	20065
Thread Direction	RH
Type	Bronze
<b>Details</b>	
Lead [in]	0.200
Starts	1
Pitch [in]	0.200
Turns Per Inch	5
Lash (Maximum Axial) [in]	0.009
Nominal Rod Diameter [in]	0.625
Threads per Inch	5
Thread Code	065
Form	2C
<b>Dimensions</b>	
B [in]	1.00
C [in]	1.13
E [in]	0.50
F (n) Dia. [in]	(4) .266
F BCD [in]	2.090
G [in]	0.53
H [in]	2.60
J [in]	.937-16
<b>Forces and Torques</b>	
Torque to Raise 1 lb. [in-lb]	0.072
<b>Flange Part Numbers</b>	
Flange No-Lash Part Number	
Flange Part Number	FLG7570
<b>Weight</b>	
Flange Weight [lb]	0.77
Nut Weight [lb]	0.23
<b>Performance Specifications</b>	
Efficiency [%]	44
Lead Accuracy +/- [in/in]	0.0003
Dynamic Load Capacity [lb]	1953
Static Load Capacity [lb]	6250