

## PowerTrac 1000 - 1000 SRT RA, with SEL Ball Nut, Adjustable

Call 800-321-7800 or visit us online at [www.nookindustries.com](http://www.nookindustries.com) to configure and order your PowerTrac 1000 - 1000 SRT RA, with SEL Ball Nut,

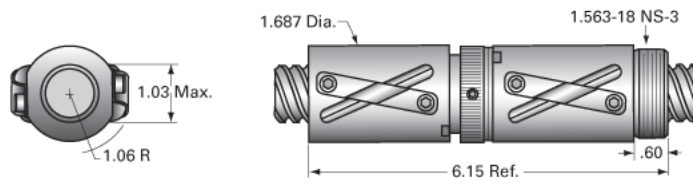

### Inch Ball Screw

#### Product Info

Screw Code	1000-1000 SRT RA
Precision	SRT
Screw Material	4150
Thread Direction	RH

#### Details

Ball Circle Diameter [in]	1.000
Lead [in]	1.000
Root Diameter [in]	0.820
End Code for Types 1,2,3,5 [* Journals may show tracings of the thread]	20
End Code for Type 4 [* Journals may show tracings of the thread]	12

#### Performance Specifications

Lead Accuracy +/- [in./ft.]	0.0040
-----------------------------	--------

#### Part Numbers

2 ft. Part Number	
4 ft. Part Number	SRT6814
6 ft. Part Number	
8 ft. Part Number	SRT6822
12 ft. Part Number	SRT6830
16 ft. Part Number	SRT0429
20 ft. Part Number	

#### Weight

Screw Weight [lb./ft.]	2.20
------------------------	------

### Inch Ball Nut, for SRT, Standard Accuracy, Preloaded, Adjustable, SEL

#### Product Info

Ball Nut Number	SEL10462
Thread Direction	RH

#### Details

Ball Circle Diameter [in]	1.000
Lead [in]	1.000
Nominal Ball Diameter [in]	0.156
Root diameter [in]	0.820

#### Forces and Torques

Torque to Raise 1 lb. [in-lb]	0.177
-------------------------------	-------

#### Flange Part Numbers

Flange Part Number	FLG7571
--------------------	---------

#### Wiper Part Numbers

Wiper Kit Part Number	WKB2650
-----------------------	---------

#### Weight

Nut Weight [lb]	2.50
-----------------	------

#### Performance Specifications

Lead Accuracy +/- [in./ft.]	0.004
Maximum Adjustable Preload [lb]	300
Spring Rate x 10 <sup>6</sup> [lb./in.]	
Dynamic Load [lb]	2142
Static Load [lb]	11925