

PowerTrac 1500 - 0250 SRT RA, with SAR Ball Nut, Adjustable

Call 800-321-7800 or visit us online at www.nookindustries.com to configure and order your PowerTrac 1500 - 0250 SRT RA, with SAR Ball Nut,

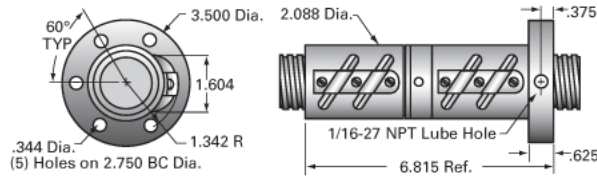

Inch Ball Screw

Product Info

| | |
|------------------|------------------|
| Screw Code | 1500-0250 SRT RA |
| Precision | SRT |
| Screw Material | 4150 |
| Thread Direction | RH |

Details

| | |
|---|-------|
| Ball Circle Diameter [in] | 1.500 |
| Lead [in] | 0.250 |
| Root Diameter [in] | 1.320 |
| End Code for Types 1,2,3,5 [* Journals may show tracings of the thread] | 30 |
| End Code for Type 4 [* Journals may show tracings of the thread] | 19 |

Performance Specifications

| | |
|-----------------------------|--------|
| Lead Accuracy +/- [in./ft.] | 0.0040 |
|-----------------------------|--------|

Part Numbers

| | |
|--------------------|---------|
| 2 ft. Part Number | |
| 4 ft. Part Number | SRT7012 |
| 6 ft. Part Number | |
| 8 ft. Part Number | SRT7020 |
| 12 ft. Part Number | SRT7028 |
| 16 ft. Part Number | SRT0433 |
| 20 ft. Part Number | SRT0595 |

Weight

| | |
|------------------------|------|
| Screw Weight [lb./ft.] | 5.16 |
|------------------------|------|

Inch Ball Nut, for SRT, Standard Accuracy, Preloaded, Adjustable, SAR

Product Info

| | |
|------------------|---------|
| Ball Nut Number | SAR3043 |
| Thread Direction | RH |

Details

| | |
|----------------------------|-------|
| Ball Circle Diameter [in] | 1.500 |
| Lead [in] | 0.250 |
| Nominal Ball Diameter [in] | 0.156 |
| Root diameter [in] | 1.320 |

Forces and Torques

| | |
|-------------------------------|-------|
| Torque to Raise 1 lb. [in-lb] | 0.044 |
|-------------------------------|-------|

Flange Part Numbers

| | |
|--------------------|----------|
| Flange Part Number | INTEGRAL |
|--------------------|----------|

Wiper Part Numbers

| | |
|-----------------------|-------|
| Wiper Kit Part Number | BRUSH |
|-----------------------|-------|

Weight

| | |
|-----------------|------|
| Nut Weight [lb] | 6.00 |
|-----------------|------|

Performance Specifications

| | |
|---|-------|
| Lead Accuracy +/- [in./ft.] | 0.004 |
| Maximum Adjustable Preload [lb] | 920 |
| Spring Rate x 10 ⁶ [lb./in.] | |
| Dynamic Load [lb] | 4198 |
| Static Load [lb] | 44030 |