

PowerAC Trapezoidal Assembly 901 RS w/Bronze Nut

Call 800-321-7800 or visit us online at www.nookindustries.com to configure and order your PowerAC Trapezoidal Assembly 901 RS w/Bronze Nut

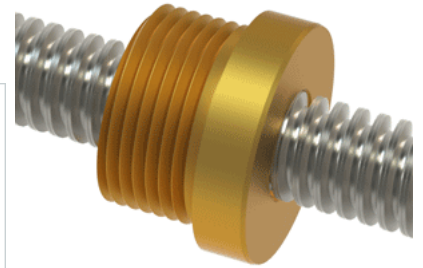

Trapezoidal Lead Screw

Product Info

Screw Code	901 RS
Screw Material	300 Series Stainless
Thread Direction	RH

Details

Diameter	12
Lead	3
Starts	1
Pitch [mm]	3
Lead Accuracy +/- [*MU*m/25mm]	6.25
Thread Code	901
End Code for Types 1,2,3,5 [* Journals may show tracings of the thread]	7
End Code for Type 4 [* Journals may show tracings of the thread]	4

Dimensions

A - Root Diameter Mmmimum [mm]	7.69
D - Nominal Rod Diameter	12

Part Numbers

1800 mm Part Number	55901
3600 mm Part Number	
900 mm Part Number	54901

Weight

Weight Per Meter [kg]	0.7
-----------------------	-----

Trapezoidal Lead Nut

Product Info

Part Number	20901
Thread Direction	RH
Type	Bronze

Details

Diameter	12
Lead [mm]	3
Starts	1
Pitch [mm]	3
Lash (Maximum Axial in) [mm]	0.16
Nominal Rod Diameter	12
Thread Code	901

Dimensions

B [mm]	19.0
C [mm]	28.0
E [mm]	13.00
F (n) Dia. [mm]	(4) 7.00
F BCD [mm]	53.00
G [mm]	14.0
H [mm]	66.0
J [mm]	M25x1.5

Forces and Torques

Torque to Raise 1 kN [Nm]	1.119
---------------------------	-------

Flange Part Numbers

Flange Part Number	72002
--------------------	-------

Weight

Flange Weight [kg]	0.31
Nut Weight [g]	84

Performance Specifications

Efficiency [%]	33
Lead Accuracy +/- [*MU*m/25mm]	6.25
Dynamic Load Capacity [N]	4963
Static Load Capacity [N]	15858