

PowerAC 1/2"-10 LA w/Bronze Nut

Call 800-321-7800 or visit us online at www.nookindustries.com to configure and order your PowerAC 1/2"-10 LA w/Bronze Nut today!

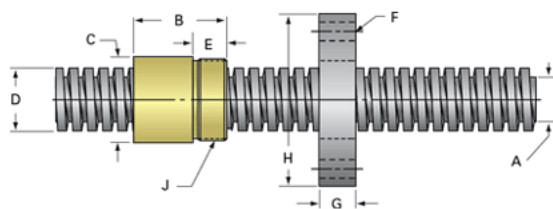
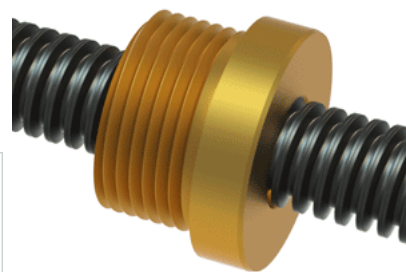

Rolled Inch Acme Screw

Product Info

Screw Code	050-LA
Thread Direction	LH
Screw Material	4140 Series

Details

Lead [in]	0.100
Starts	1
Pitch [in]	0.100
Turns Per Inch	10
Threads per Inch	10
Thread Code	050
Form	2C
End Code for Types 1,2,3,5 [* Journals may show tracings of the thread]	9
End Code for Type 4 [* Journals may show tracings of the thread]	6*

Dimensions

A - Root Diameter Minimum [in]	0.359
D - Nominal Rod Diameter [in]	0.500

Part Numbers

3 ft. Part Number	51050
6 ft. Part Number	52050
12 ft. Part Number	53050
20 ft. Part Number	

Performance Specifications

Lead Accuracy +/- [in/in]	0.0003
---------------------------	--------

Weight

Screw Weight [lb./ft.]	0.53
------------------------	------

Inch Acme Nut with Optional Flange

Product Info

Part Number	80050
Thread Direction	LH
Type	Bronze

Details

Lead [in]	0.100
Starts	1
Pitch [in]	0.100
Turns Per Inch	10
Lash (Maximum Axial) [in]	0.007
Nominal Rod Diameter [in]	0.500
Threads per Inch	10
Thread Code	050
Form	2C

Dimensions

B [in]	0.75
C [in]	1.12
E [in]	0.50
F (n) Dia. [in]	(4) .266
F BCD [in]	2.090
G [in]	0.53
H [in]	2.60
J [in]	.937-16

Forces and Torques

Torque to Raise 1 lb. [in-lb]	0.047
-------------------------------	-------

Flange Part Numbers

Flange No-Lash Part Number	
Flange Part Number	FLG7570

Weight

Flange Weight [lb]	0.77
Nut Weight [lb]	0.18

Performance Specifications

Efficiency [%]	34
Lead Accuracy +/- [in/in]	0.0003
Dynamic Load Capacity [lb]	1250
Static Load Capacity [lb]	4000