

NRS SF 2W 39x20 w/Wiper

Call 800-321-7800 or visit us online at www.nookindustries.com to configure and order your NRS SF 2W 39x20 w/Wiper today!

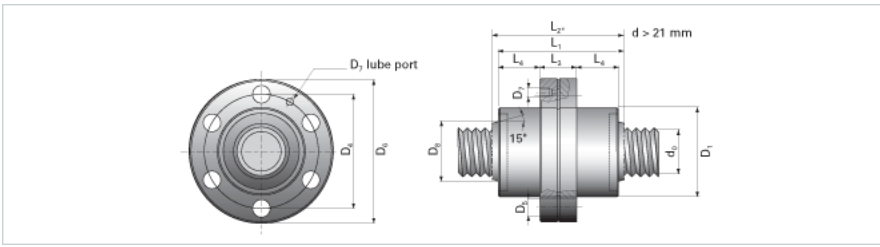

Product Info

Nominal Rod Diameter [mm] 39

Details

Lead [mm] 20

End Code for Types 1,2,3,5 [* Journals may show tracings of the thread] 35

Dimensions

D1 [mm] 80
 D4 [mm] 102
 D6 [mm] 124
 D7 [mm] M6
 D8 [mm] 54
 L1 [mm] 110
 L2 [mm] 126
 L3 [mm] 38.5
 L4 [mm] 33.5
 n x D5 6x11

Performance Specifications

Dynamic Load Ratings Ca [kN] 86.70
 Static Load Ratings Coa [kN] 109.20