

Type 2L, End Code 95

Call 800-321-7800 or visit us online at www.nookindustries.com to configure and order your Type 2L, End Code 95 today!

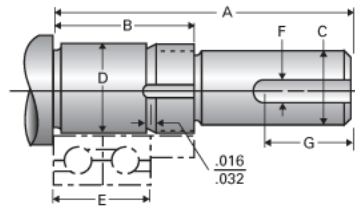

Product Info

Nominal Bearing Journal Size 95

Dimensions

C Maximum [in]	3.500
C Minimum [in]	3.499
D Maximum [in]	3.7402
D Minimum [in]	3.7394
F [in]	N/A
G [in]	N/A
Typical Journal for Single Bearing A [in]	11.37
Typical Journal for Single Bearing B [in]	4.37
Typical Journal for Single Bearing E [in]	3.544
Lock Nut	AN-19
Lock Washer	W-19