

Type 2L, End Code 9

Call 800-321-7800 or visit us online at www.nookindustries.com to configure and order your Type 2L, End Code 9 today!

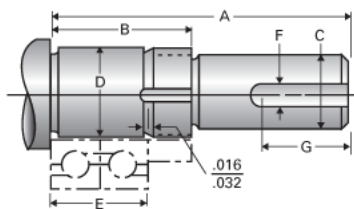

Product Info

Nominal Bearing Journal Size 9

Dimensions

C Maximum [in]	0.250
C Minimum [in]	0.249
D Maximum [in]	0.3544
D Minimum [in]	0.3541
F [in]	N/A
G [in]	N/A
Typical Journal for Single Bearing A [in]	1.69
Typical Journal for Single Bearing B [in]	1.04
Typical Journal for Single Bearing E [in]	0.630
Lock Nut	5/16-24
Lock Washer	N/A