

PowerTrac SEL 1500 - 1000 RH, Adjustable Preloaded

Call 800-321-7800 or visit us online at www.nookindustries.com to configure and order your PowerTrac SEL 1500 - 1000 RH, Adjustable Preloaded

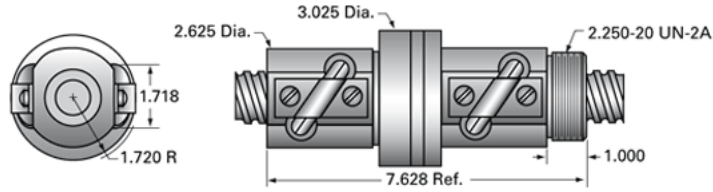

Product Info

Ball Nut Number	SEL0698
Thread Direction	RH

Details

Ball Circle Diameter [in]	1.500
Lead [in]	1.000
Nominal Ball Diameter [in]	0.344
Root diameter [in]	1.140

Forces and Torques

Torque to Raise 1 lb. [in-lb]	0.177
-------------------------------	-------

Flange Part Numbers

Flange Part Number	FLG7777
--------------------	---------

Wiper Part Numbers

Wiper Kit Part Number	WKB2657
-----------------------	---------

Weight

Nut Weight [lb]	9.10
-----------------	------

Performance Specifications

Lead Accuracy +/- [in./ft.]	0.004
Maximum Adjustable Preload [lb]	1650
Spring Rate x 10 ⁶ [lb./in.]	
Dynamic Load [lb]	7560
Static Load [lb]	34662