

PowerTrac SBN 0375 - 0125 LH, Double Circuit

Call 800-321-7800 or visit us online at www.nookindustries.com to configure and order your PowerTrac SBN 0375 - 0125 LH, Double Circuit today!

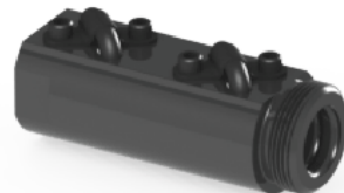
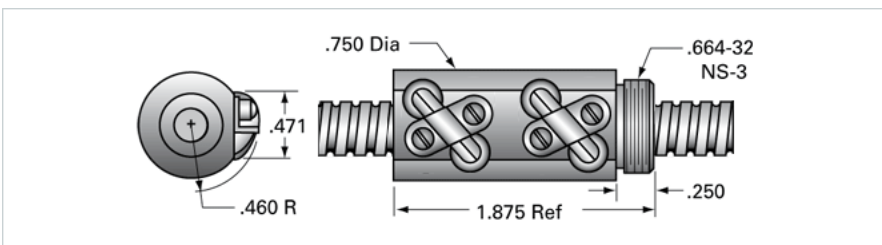

Product Info

Ball Nut Number	SBN8282
Thread Direction	LH

Details

Ball Circle Diameter [in]	0.375
Lead [in]	0.125
Nominal Ball Diameter [in]	0.063
Root diameter [in]	0.300

Dimensions

A [in]

Forces and Torques

Torque to Raise 1 lb. [in-lb]	0.022
-------------------------------	-------

Flange Part Numbers

Flange Part Number	FLG6751
--------------------	---------

Wiper Part Numbers

Wiper Kit Part Number	-
Wiper Kit Felt Part Number	-

Weight

Nut Weight [lb]	0.21
-----------------	------

Performance Specifications

Lead Accuracy +/- [in./ft.]	0.004
Maximum Adjustable Preload [lb]	
Spring Rate x 10 ⁶ [lb./in.]	
Dynamic Load [lb]	272
Static Load [lb]	2830