

## PowerTrac PRN 0875 - 0200 RH, Preloaded

Call 800-321-7800 or visit us online at [www.nookindustries.com](http://www.nookindustries.com) to configure and order your PowerTrac PRN 0875 - 0200 RH, Preloaded today!

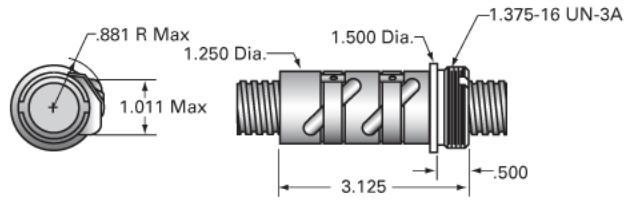

### Product Info

Ball Nut Number	PRN10110
Thread Direction	RH

### Details

Ball Circle Diameter [in]	0.875
Lead [in]	0.200
Nominal Ball Diameter [in]	0.125
Root diameter [in]	0.735

### Forces and Torques

Torque to Raise 1 lb. [in-lb]	0.035
-------------------------------	-------

### Flange Part Numbers

Flange Part Number	FLG8281
--------------------	---------

### Wiper Part Numbers

Wiper Kit Part Number	ELASTOMER
-----------------------	-----------

### Weight

Nut Weight [lb]	1.10
-----------------	------

### Performance Specifications

Maximum Adjustable Preload [lb]	
Spring Rate x 10 <sup>6</sup> [lb./in.]	3.10
Dynamic Load [lb]	1375
Static Load [lb]	10780