

PowerTrax LBB OPN-1500

Call 800-321-7800 or visit us online at www.nookindustries.com to configure and order your PowerTrax LBB OPN-1500 today!

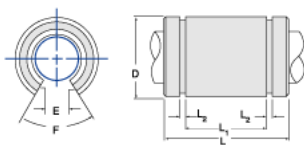

Product Info

| | |
|-----------------------------|----------|
| Nominal Shaft Diameter [in] | 1 1/2 |
| Part Number | OPN-1500 |

Dimensions

| | |
|----------------|--------|
| D Maximum [in] | 2.3750 |
| D Minimum [in] | 2.3745 |
| E [in] | 3/4 |
| L [in] | 3.000 |
| L1 [in] | 2.250 |
| L2 [in] | 0.088 |

Weight

| | |
|-------------|------|
| Weight [lb] | 1.44 |
|-------------|------|

Performance Specifications

| | |
|-------------------|-----|
| F | 60° |
| Dynamic Load [lb] | 948 |
| Static Load [lb] | 845 |