

## PowerTrax LBB OPN-1000

Call 800-321-7800 or visit us online at [www.nookindustries.com](http://www.nookindustries.com) to configure and order your PowerTrax LBB OPN-1000 today!

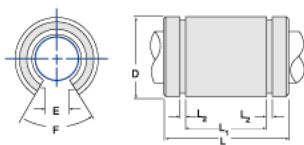

|                                   |          |
|-----------------------------------|----------|
| <b>Product Info</b>               |          |
| Nominal Shaft Diameter [in]       | 1        |
| Part Number                       | OPN-1000 |
| <b>Dimensions</b>                 |          |
| D Maximum [in]                    | 1.5625   |
| D Minimum [in]                    | 1.5621   |
| E [in]                            | 52/15625 |
| L [in]                            | 2.250    |
| L1 [in]                           | 1.625    |
| L2 [in]                           | 0.070    |
| <b>Weight</b>                     |          |
| Weight [lb]                       | 0.5      |
| <b>Performance Specifications</b> |          |
| F                                 | 60°      |
| Dynamic Load [lb]                 | 445      |
| Static Load [lb]                  | 438      |