

## RAD-20048-HD/20XX

Call 800-321-7800 or visit us online at [www.nookindustries.com](http://www.nookindustries.com) to configure and order your RAD-20048-HD/20XX today!

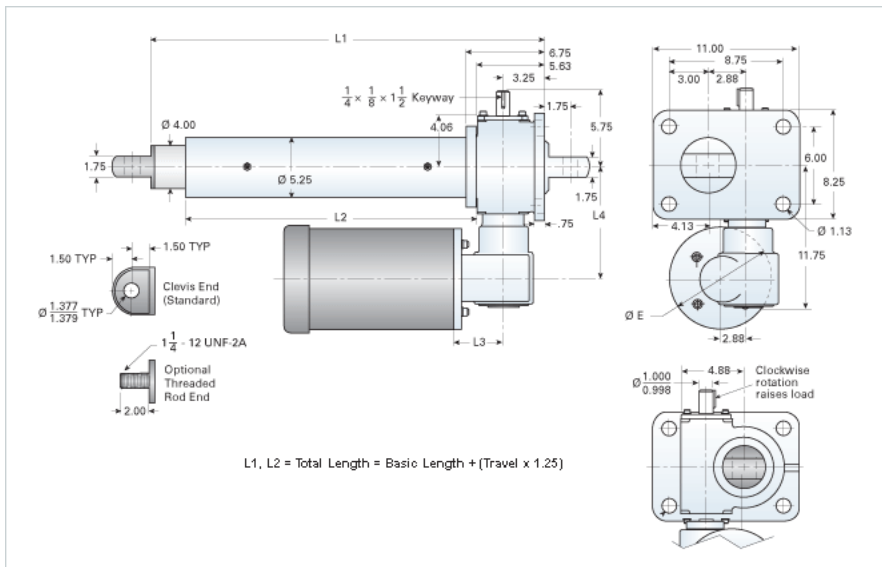

### Performance Specifications

|  |        |
|--|--------|
| Travel Rate [in/min]                         | 4.5    |
| Dynamic Capacity [lb]                        | 40000  |
| Rated Life [in]                              | 150000 |
| Motor Horse Power                            | 2      |
| Maximum Rod Reaction Torque [in-lb]          | 3540   |
| Std. Brake Torque [ft-lb]                    | 10     |
| Approximate Stopping Distance No Load [in]   | 0.01   |
| Approximate Stopping Distance Full Load [in] | 0.01   |

### Details

|                                |        |
|--------------------------------|--------|
| Gear Ratio Primary Reduction   | 24:1   |
| Gear Ratio Secondary Reduction | 8:1    |
| Input Turns Per Inch Of Travel | 384    |
| Torque To Raise 1 lb. [in-lb]  | 0.0016 |
| Max Capacity [lb]              | 40000  |
| Max HP [hp]                    | 2      |

### Weight

|                         |      |
|-------------------------|------|
| Basic Weight [lb]       | 202  |
| Per Inch of Travel [lb] | 3.31 |

### Tube Dimensions

|                      |       |
|----------------------|-------|
| L1 Basic Length [in] | 21.13 |
| L2 Basic Length [in] | 12.63 |

### NEMA 56C Dimensions

|         |   |
|---------|---|
| L3 [in] | - |
| L4 [in] | - |
| E [in]  | - |

### NEMA 180TC Dimensions

|         |      |
|---------|------|
| L3 [in] | 6.12 |
| L4 [in] | 9.00 |
| F [in]  | 9.12 |