

**FOR ORDERING**  
SPECIFY "L"  
DIMENSION  
L (min) =  
TRAVEL + 370

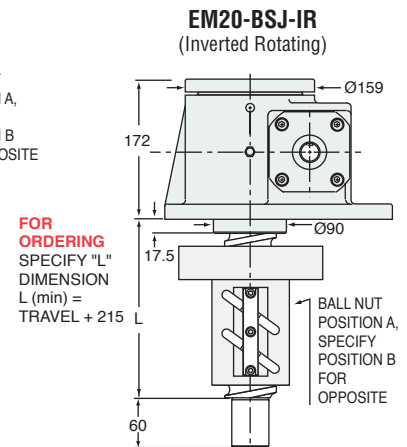

**FOR ORDERING**  
SPECIFY "L"  
DIMENSION  
L (min) =  
TRAVEL + 215

METRIC BALL SCREW JACKS TECHNICAL DATA

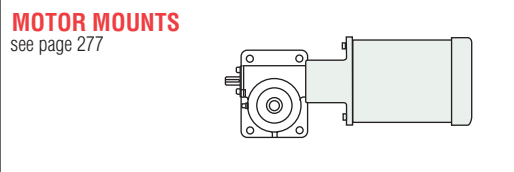
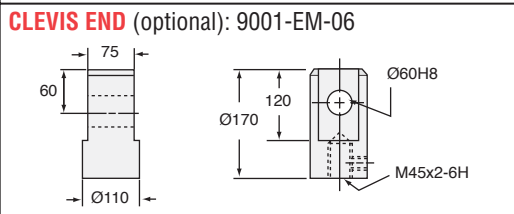
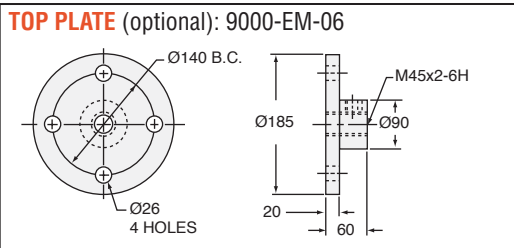

**BALL NUT & FLANGE DIMENSIONS**

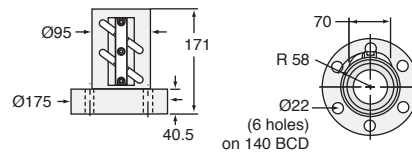

**EM20-BSJ SCREW**

SCREW: MRT63x12  
 ROOT DIAMETER: 57.0  
 DRAG TORQUE: 4.52  
 START TORQUE: 2 x Running Torque  
 WEIGHT (Approx. in Kg)  
 "0" TRAVEL: 38.6  
 PER 100mm TRAVEL: 2.31  
 GREASE: 1.0

RATIO	TRAVEL PER 1 TURN OF WORM	TORQUE TO RAISE ONE kN NON-KEYED	MAX. kW	MAX. WORM SPEED AT RATED LOAD NON-KEYED	MAX. LOAD AT 1425 RPM NON-KEYED
8:1	1.5 mm	0.38 Nm	5.6	710 rpm	99.8 kN
24:1	0.5 mm	0.19 Nm	1.9	470 rpm	66.1 kN

**CAUTION!** JACK IS SELF-LOWERING. LIFTING SCREW OR NUT MUST BE SECURED TO PREVENT ROTATION FOR NON-KEYED UNITS.