

BALL NUT & FLANGE DIMENSIONS

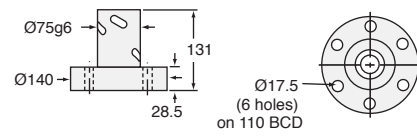

EM10-BSJ SCREW

SCREW: MRT50x10
 ROOT DIAMETER: 45.2
 DRAG TORQUE: 2.26
 START TORQUE: 2 x Running Torque
 WEIGHT (Approx. in Kg)
 "0" TRAVEL: 22.7
 PER 100mm TRAVEL: 1.46
 GREASE: 0.68

RATIO	TRAVEL PER 1 TURN OF WORM	TORQUE TO RAISE ONE kN NON-KEYED	MAX. kW	MAX. WORM SPEED AT RATED LOAD NON-KEYED	MAX. LOAD AT 1425 RPM NON-KEYED
8:1	1.25 mm	0.32 Nm	3.75	1125 rpm	78.9 kN
24:1	0.42 mm	0.16 Nm	1.12	665 rpm	46.6 kN

CAUTION! JACK IS SELF-LOWERING. LIFTING SCREW OR NUT MUST BE SECURED TO PREVENT ROTATION FOR NON-KEYED UNITS.