

METRIC BALL SCREW JACKS TECHNICAL DATA

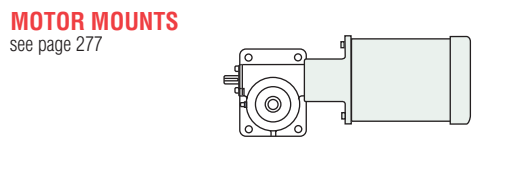

**BALL NUT & FLANGE DIMENSIONS**

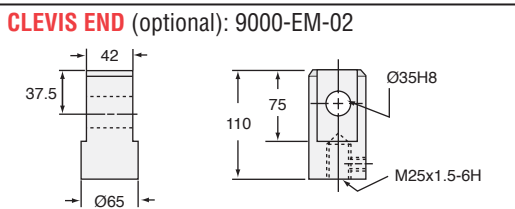
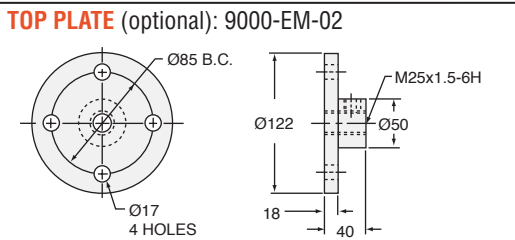
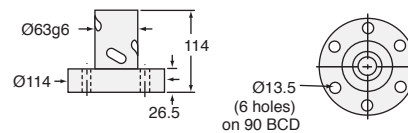

**EM5-BSJ SCREW**

SCREW: MRT40x10  
 ROOT DIAMETER: 34.8  
 DRAG TORQUE: 1.13  
 START TORQUE: 2 x Running Torque  
 WEIGHT (Approx. in Kg)  
 "0" TRAVEL: 15.9  
 PER 100mm TRAVEL: 0.93  
 GREASE: 0.45

RATIO	TRAVEL PER 1 TURN OF WORM	TORQUE TO RAISE ONE kN NON-KEYED	MAX. kW	MAX. WORM SPEED AT RATED LOAD NON-KEYED	MAX. LOAD AT 1425 RPM NON-KEYED
6:1	1.67 mm	0.39 Nm	2.28	1125 rpm	39.4 kN
24:1	0.42 mm	0.15 Nm	0.56	695 rpm	24.4 kN

**CAUTION!** JACK IS SELF-LOWERING. LIFTING SCREW OR NUT MUST BE SECURED TO PREVENT ROTATION FOR NON-KEYED UNITS.