

BALL NUT & FLANGE DIMENSIONS

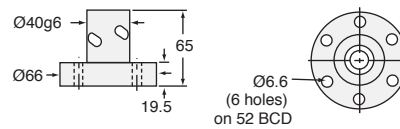

EM2.5-BSJ SCREW
SCREW: MRT25x5
ROOT DIAMETER: 22.5
DRAG TORQUE: 0.56
START TORQUE: 2 x Running Torque
WEIGHT (Approx. in Kg)
"0" TRAVEL: 7.7
PER 100mm TRAVEL: 0.36
GREASE: 0.22

RATIO	TRAVEL PER 1 TURN OF WORM	TORQUE TO RAISE ONE kN NON-KEYED	MAX. kW	MAX. WORM SPEED AT RATED LOAD NON-KEYED	MAX. LOAD AT 1425 RPM NON-KEYED
6:1	0.83 mm	0.20 Nm	1.08	2035 rpm	25.0 kN
12:1	0.42 mm	0.12 Nm	0.65	2035 rpm	25.0 kN
24:1	0.21 mm	0.09 Nm	0.38	1695 rpm	25.0 kN

CAUTION! JACK IS SELF-LOWERING. LIFTING SCREW OR NUT MUST BE SECURED TO PREVENT ROTATION FOR NON-KEYED UNITS.