

# 16mm Carry™ METRIC THREAD

**LEAD ACCURACY:** ±100µm/300mm

## Carry Type Z Ball Nut

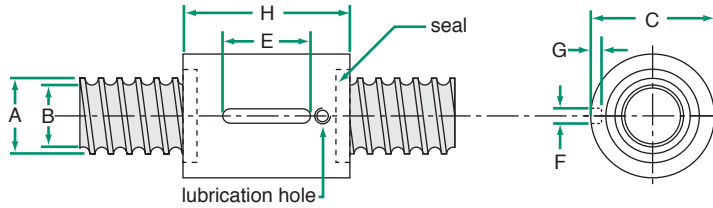

dimensions in mm

SCREW SPECIFICATIONS						NUT SPECIFICATIONS												
dia x lead	helix	reference number*	A	B root dia	wgt. (g/m)	part number	C	H	E	F	G	lash	wiper**	ball return location	wgt. (g)	torque to raise 1 kN (N·m)	load rating (N)	
																	Dyn. (C <sub>a</sub> )	Static (C <sub>0a</sub> )
16 x 5	RH	ECS-16050-R□	15.7	13.0	1251	ECN-16050-□ZU	30	43	16	4	2.5	0.07	Plastic	Internal	113	0.889	9700	22000

\*Lengths available up to 3,000 mm. See page 154 and 174 to complete reference number \*\*All nuts with wiper feature an M5 lubrication hole.

## Carry Type FG Ball Nut

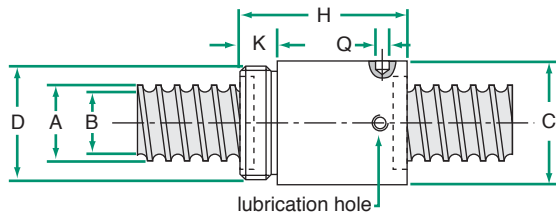

dimensions in mm

SCREW SPECIFICATIONS						NUT SPECIFICATIONS												
dia x lead	helix	reference number*	A	B root dia	wgt. (g/m)	part number	C	D	H	K	Q	lash	wiper**	ball return location	wgt. (g)	torque to raise 1 kN (N·m)	load rating (N)	
																	Dyn. (C <sub>a</sub> )	Static (C <sub>0a</sub> )
16 x 2	RH	ECS-16020-RA	16.0	14.5	1416	ECN-16020-RGU	30	M26x1.5	28	12	3.5	0.06	Plastic	External	76	0.356	2500	5500
16 x 5	RH	ECS-16050-R□	15.7	13.0	1251	ECN-16050-□GU	30.2	M26x1.5	50	12	3.5	0.07	Plastic	Internal	123	0.889	9700	22000
16 x 5	RH	ECS-16050-R□	15.7	13.0	1251	ECN-16050-□DN	32	M26x1.5	42	12	4	0.07	—	External	144	0.889	12000	25000
16 x 5	RH	ECS-16050-R□	15.7	13.0	1251	ECN-16020-□DU	32	M26x1.5	47	12	4	0.07	Plastic	External	164	0.889	12000	25000
16 x 10	RH	ECS-16100-RA	15.7	13.0	1251	ECN-16100-RGN	32	M26x1.5	47	12	4	0.07	—	External	165	1.778	17000	25000
16 x 10	RH	ECS-16100-RA	15.7	13.0	1251	ECN-16100-RGU	32	M26x1.5	52	12	4	0.07	Plastic	External	184	1.788	17000	25000

\*Lengths available up to 3,000 mm. See page 154 and 174 to complete reference number \*\*All nuts with wiper feature an M5 lubrication hole.

### BALL SCREW ASSEMBLIES

These assemblies are shipped with screw, nut, flange, and bearing supports.

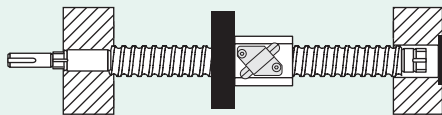

See page 145 for complete product details.

### EZZE-MOUNT™ END BEARING SUPPORTS

A convenient solution for mounting ball screw assemblies.

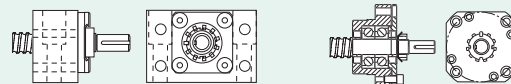

Single or Double Bearing  
Universal Mount

Single or Double Bearing  
Flange Mount

See page 214 for complete product details.