

# 12mm Carry™ METRIC THREAD

**LEAD ACCURACY:** ±100µm/300mm

## Carry Type Z Ball Nut

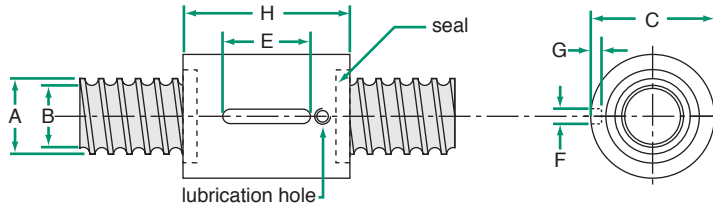

dimensions in mm

SCREW SPECIFICATIONS						NUT SPECIFICATIONS												
dia x lead	helix	reference number*	A	B root dia	wgt. (g/m)	part number	C	H	E	F	G	lash	wiper**	ball return location	wgt. (g)	torque to raise 1 kN (N·m)	load rating (N)	
																	Dyn. (C <sub>a</sub> )	Static (C <sub>0a</sub> )
12 x 2	RH	ECS-12020-RA	12.0	10.6	750	ECN-12020-RZN	20	15	10	3	1.2	0.06	—	Internal	19	0.356	1380	2500
12 x 4	RH	ECS-12040-R□	12.0	9.8	739	ECN-12040-□ZN	26	24	10	3	1.8	0.07	—	External	68	0.711	5500	11000
12 x 4	RH	ECS-12040-R□	12.0	9.8	739	ECN-12040-□ZU	26	32	10	3	1.8	0.07	Plastic	External	70	0.711	5500	11000

\*Lengths available up to 3,000 mm. See page 154 and 174 to complete reference number \*\*All nuts with wiper feature an M5 lubrication hole.

## Carry Type FG Ball Nut

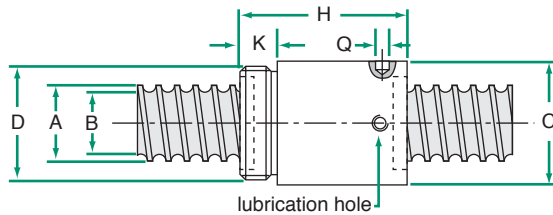

dimensions in mm

SCREW SPECIFICATIONS						NUT SPECIFICATIONS												
dia x lead	helix	reference number*	A	B root dia	wgt. (g/m)	part number	C	D	H	K	Q	lash	wiper**	ball return location	wgt. (g)	torque to raise 1 kN (N·m)	load rating (N)	
																	Dyn. (C <sub>a</sub> )	Static (C <sub>0a</sub> )
12 x 2	RH	ECS-12020-RA	12.0	10.6	750	ECN-12020-RGN	20	M18x1	23	8	2.5	0.06	—	Internal	24	0.356	1380	2500
12 x 4	RH	ECS-12040-R□	12.0	9.8	739	ECN-12040-□GN	26	M20x1	32	8	2.5	0.07	—	External	83	0.711	5500	11000
12 x 4	RH	ECS-12040-R□	12.0	9.8	739	ECN-12040-□GU	26	M20x1	34	10	2.5	0.07	Plastic	External	84	0.711	5500	11000
12 x 5	RH	ECS-12050-R□	12.0	9.5	737	ECN-12050-□G□	26	M20x1	37	8	2.5	0.07	Plastic	External	87	0.889	6600	12000
12.7 x 12.7	RH	ECS-12120-R□	13.1	10.3	880	ECN-12120-□G□	29.5	M25x1.5	50	12	3	0.07	Brush	External	134	2.235	8000	15500

\*Lengths available up to 3,000 mm. See page 154 and 174 to complete reference number \*\*All nuts with wiper feature an M5 lubrication hole.

## Carry Type FB Ball Nut

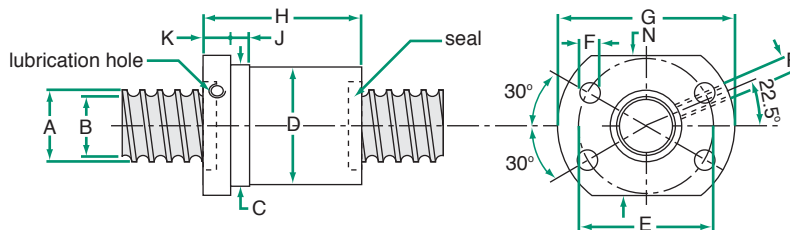

dimensions in mm

SCREW SPECIFICATIONS						NUT SPECIFICATIONS																	
dia x lead	helix	reference number*	A	B root dia	wgt. (g/m)	part number	C	D	E	F	G	H	J	K	N	P	lash	wiper**	ball return location	wgt. (g)	torque to raise 1 kN (N·m)	load rating (N)	
																					Dyn. (C <sub>a</sub> )	Static (C <sub>0a</sub> )	
12 x 4	RH	ECS-12040-R□	12.0	9.8	739	ECN-12040-□BU	26	25.5	32	4.5	39.5	36	5	8	28	M5	0.07	Plastic	External	126	0.711	5500	11000
12 x 5	RH	ECS-12050-R□	12.0	9.5	737	ECN-12050-□BU	26	25.5	32	4.5	39.5	40	5	7	28	M5	0.07	Plastic	External	126	0.889	6600	12000

\*Lengths available up to 3,000 mm. See page 154 and 174 to complete reference number \*\*All nuts with wiper feature an M5 lubrication hole.

METRIC BALL SCREW AND NUT TECHNICAL DATA