

1000-0250 SRT continued

LEAD ACCURACY: ±0.004 in./ft.

Single Start

- 1.000** Ball Circle Diameter
- 0.250** Lead
- 0.820** Root Diameter
- 0.156** Nominal Ball Diameter
- 2.2** Screw Weight (lbs./ft.)

Standard Screw Lengths	PART NUMBERS		
	RH	LH	RHSS
4 FT.	SRT5005	SRT5499	SRT6668
8 FT.	SRT5013	SRT5507	SRT6676
12 FT.	SRT5021	SRT5515	SRT6684
16 FT.	SRT0426	SRT0428	—

Custom cut lengths available up to 24' for alloy, up to 12' for stainless.
For longer lengths contact Customer Service.

INCH BALL SCREW AND NUT TECHNICAL DATA

SEL Preload Ball Nut

86 bearing balls per circuit - 172 total per nut

PRODUCT SPECIFICATIONS	RH	LH	RHSS
Dynamic Load (lbs.)	1,612	1,612	—
Static Load (lbs.)	13,913	13,913	—
Torque to Raise 1 lb. (in.-lb.)	.044	.044	—
Preload (lbs.)	330	330	—
Nut Weight (lbs.)	1.9	1.9	—
Ball Nut Number	SEL10474	SEL10477	—
Flange Part Number	FLG7571	FLG7571	—
Wiper Kit Part Number	WKB1050	WKB1050	—

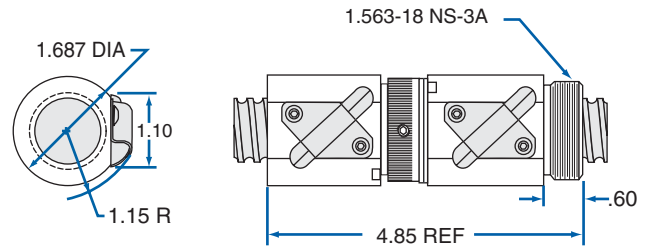

SAR Adjustable Preload Flanged Ball Nut

86 bearing balls per circuit - 172 total per nut

PRODUCT SPECIFICATIONS	RH	LH	RHSS
Dynamic Load (lbs.)	1,612	—	—
Static Load (lbs.)	13,913	—	—
Torque to Raise 1 lb. (in.-lb.)	.044	—	—
Preload Range (lbs.)	330	—	—
Nut Weight (lbs.)	2.0	—	—
Ball Nut Number	SAR3041	—	—
Flange	INTEGRAL	—	—
Wiper Type	—	—	—

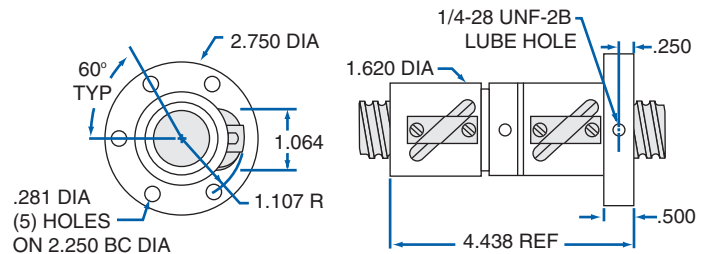

BALL SCREW ASSEMBLIES

These assemblies are shipped with screw, nut, flange, and bearing supports.

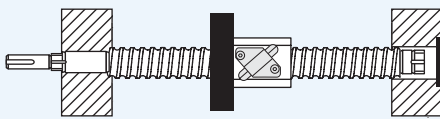

See page 145 for complete product details.

EZZE-MOUNT™ END BEARING SUPPORTS

A convenient solution for mounting ball screw assemblies.

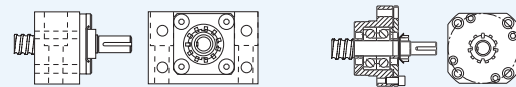

Single or Double Bearing Universal Mount

Single or Double Bearing Flange Mount

See page 214 for complete product details.

TWIN-LEAD SCREW

Single piece twin-lead screws offer opposing motion through a single drive system.

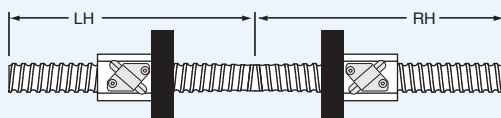

See page 148 for complete product details.

LUBRICANT

Prolong ball screw and nut performance with this special lubricant.



E-900 12oz. Spray or 32oz. Liquid
See page 95 for complete product details.