

**ILA-100-HD / X05 / TC / 24.5 / S**

**SERIES ILA MODEL**

Refer to product pages for available models.

- ILA = Standard In-Line Actuator
- ILAK = Keyed In-Line Actuator

**MOTOR MOUNT CODES \***

Motor Mounts Without Motor (Refer to product pages for available models.)

**NEMA Frame Mounts**

- X04 = (48C) ILA-5, ILAK-5, ILA-10, ILAK-10
- X05 = (56C) All models except ILA-200, ILAK-200
- X14 = (140TC) All models except ILA-5, ILAK-5, ILA-10, ILAK-10
- X18 = (180TC) ILA-100, ILAK-100, ILA 200, ILAK-200
- X21 = (210TC) ILA-100, ILAK-100, ILA 200, ILAK-200

**IEC Frame Mounts**

- 56B5 = ILA-5, ILAK-5
- 56B14 = ILA-5, ILAK-5
- 63B5 = ILA-10, ILAK-10
- 63B14 = ILA-10, ILAK-10
- 71B5 = ILA-10, ILAK-10, ILA-25, ILAK-25
- 71B14 = ILA-10, ILAK-10, ILA-25, ILAK-25
- 80B5 = ILA-25, ILAK-25, ILA-100, ILAK-100
- 80B14 = ILA-25, ILAK-25, ILA-100, ILAK-100
- 90B5 = ILA-100, ILAK-100
- 90B14 = ILA-100, ILAK-100
- 100B5 = ILA-100, ILAK-100, ILA0-200, ILAK-200
- 100B14 = ILA 100, ILAK-100, ILA0-200, ILAK-200

\*Unless specified at the time of order, the electric cylinder will be supplied with a jaw-type coupling that may reduce the allowable torque input. For more information please contact Nook application engineers.

**HOUSING CONFIGURATION**

T = Standard Trunnion Mount

**ROD CONFIGURATION**

- T = Threaded End
- C = Clevis End
- D = Threaded rod end with female clevis installed
- P = Top Plate

**TRAVEL**

Travel in inches

**MODIFIER LIST**

Always S, B or M

- S = Standard, no additional description required
- B = Bellows Boots (See pages 280-281)
- M = Modified, additional description required



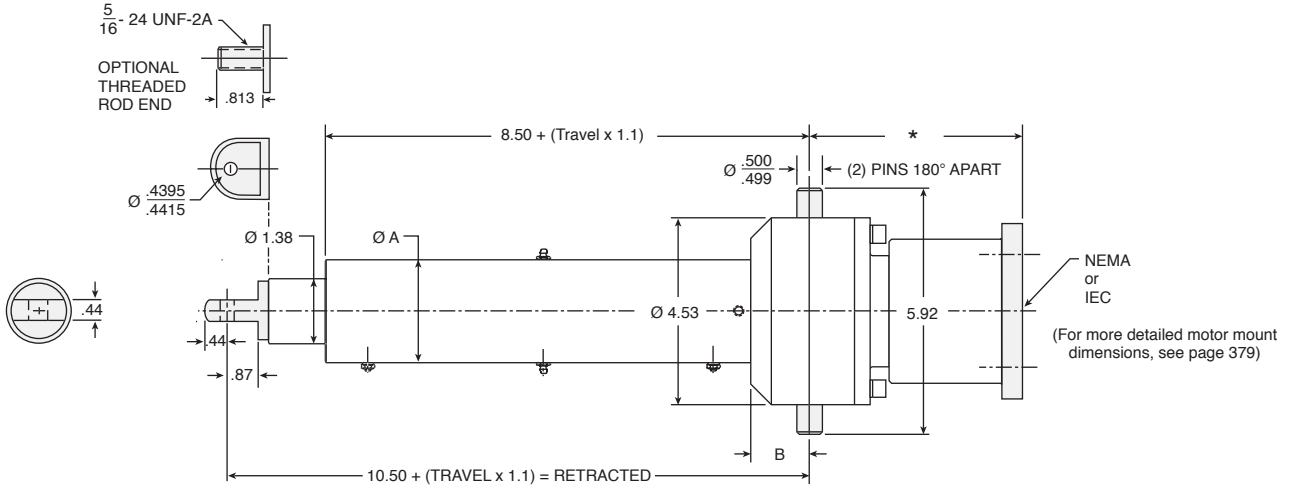

\* DIMENSION BASED ON MOTOR MOUNT, contact factory with your specific requirements.

ILA-5 & ILAK-5 BALL SCREW MODELS							
MODEL NUMBER	MAXIMUM LOAD [lb.]	MAX. INPUT TORQUE [in.-lb.]	MAX. TRAVEL RATE [in./min.]	BALL SCREW	TORQUE PER LB. [in.-lb.]	DIMENSIONS	
						A	B
ILA-5 HL	1,000	88	2,377	0631-0500 SRT	0.088	2.25	1.38
ILA-5 HD	1,000	35	951	0631-0200 SRT	0.035	2.25	1.38
ILAK-5 HL (Keyed)	1,000	88	2,377	0631-0500 SRT	0.088	3.50	1.10
ILAK-5 HD (Keyed)	1,000	35	951	0631-0200 SRT	0.035	3.50	1.10

**ROD REACTION TORQUE** = TORQUE PER LB. x LOAD

**NOTE:** CYLINDER IS SELF-LOWERING. INPUT SHAFT MUST BE SECURED TO PREVENT ROTATION.

## SERIES ILA-5 & ILAK-5

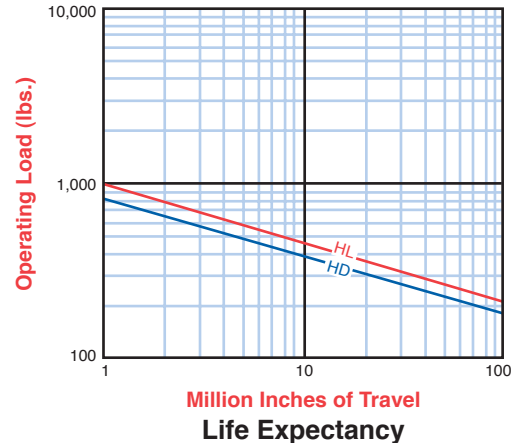
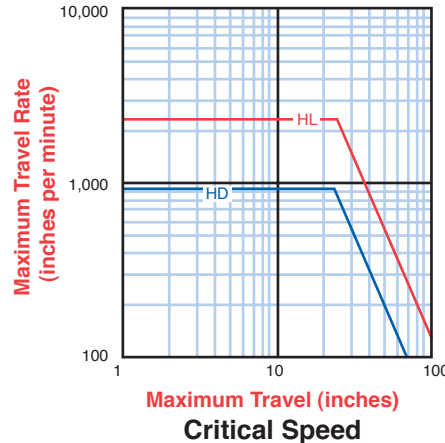
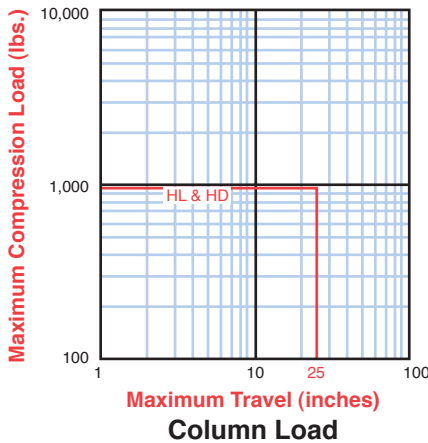

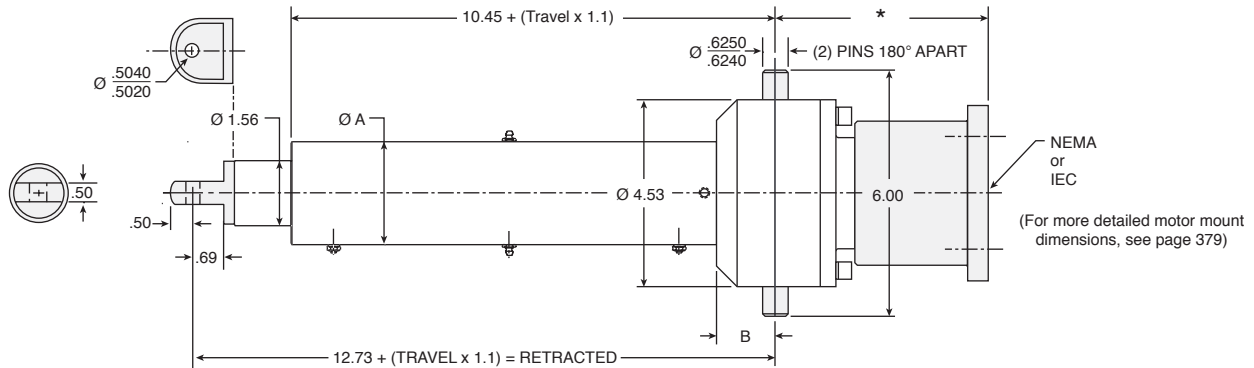
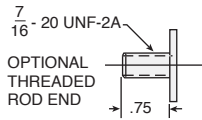

\* DIMENSION BASED ON MOTOR MOUNT, contact factory with your specific requirements.

## ILA-10 & ILAK-10 BALL SCREW MODELS

MODEL NUMBER	MAXIMUM LOAD [lb.]	MAX. INPUT TORQUE [in.-lb.]	MAX. TRAVEL RATE [in.-min.]	BALL SCREW	TORQUE PER LB. [in.-lb.]	DIMENSIONS	
						A	B
ILA-10 HL	1,200	105	2,000	0750-0500 SRT	0.088	2.50	1.44
ILA-10-HD	2,200	77	800	0750-0200 SRT	0.035	2.50	1.44
ILAK-10 HL (Keyed)	1,200	105	2,000	0750-0500 SRT	0.088	4.00	1.25
ILAK-10 HD (Keyed)	2,200	77	800	0750-0200 SRT	0.035	4.00	1.25

ROD REACTION TORQUE = TORQUE PER LB. x LOAD

## SERIES ILA-10 & ILAK-10

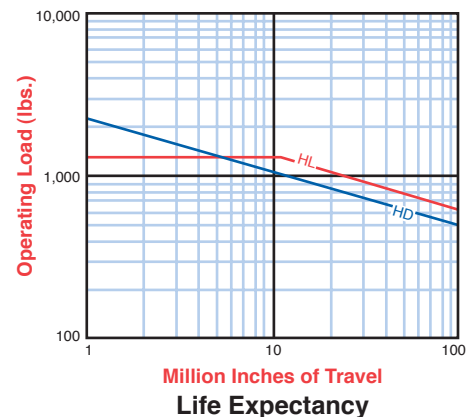
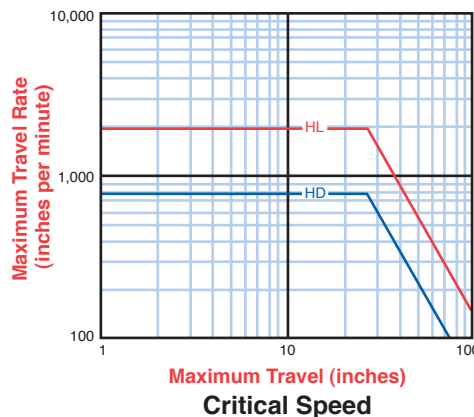
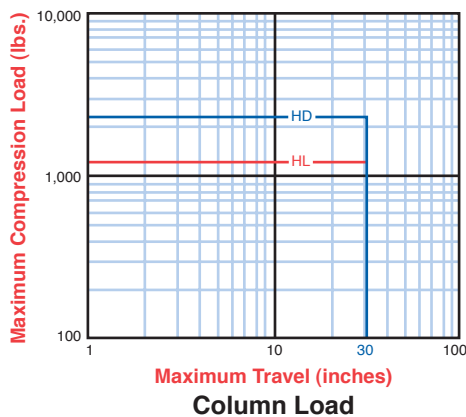

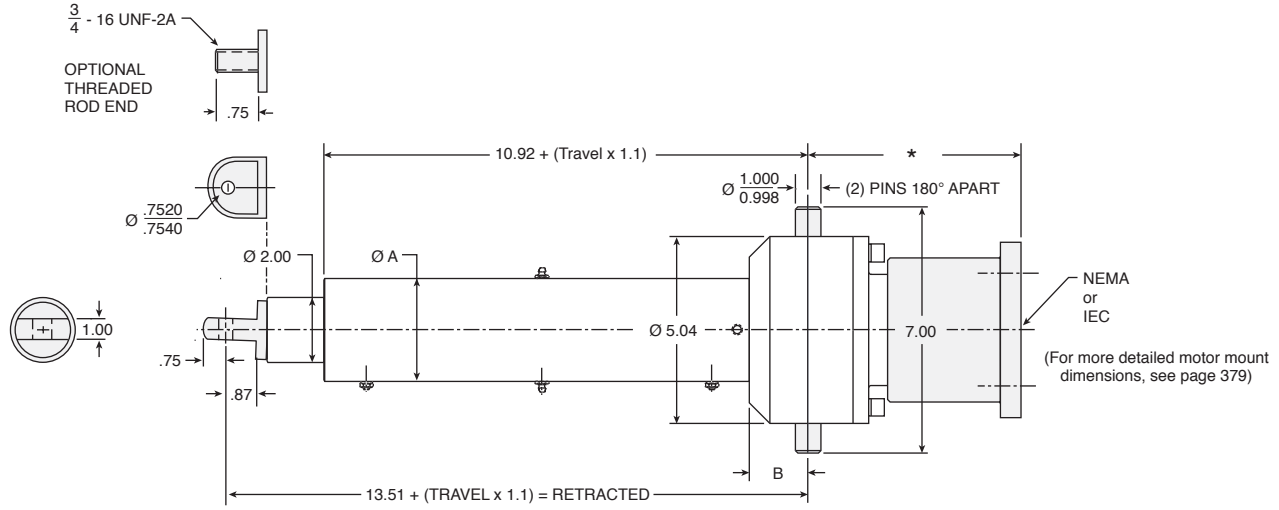

\* DIMENSION BASED ON MOTOR MOUNT, contact factory with your specific requirements.

ILA-25 & ILAK-25 BALL SCREW MODELS							
MODEL NUMBER	MAXIMUM LOAD [lb.]	MAX. INPUT TORQUE [in.-lb.]	MAX. TRAVEL RATE [in./min.]	BALL SCREW	TORQUE PER LB. [in.-lb.]	DIMENSIONS	
						A	B
ILA-25 HL	2,200	390	3,000	1000-1000 SRT	0.177	3.00	1.50
ILA-25-ML	3,500	308	1,500	1000-0500 SRT	0.088	3.00	1.50
ILA-25-HD	3,500	154	750	1000-0250 SRT	0.035	3.00	1.50
ILAK-25 HL (Keyed)	2,200	390	3,000	1000-1000 SRT	0.177	4.00	1.25
ILAK-25-ML (Keyed)	3,500	308	1,500	1000-0500 SRT	0.088	4.00	1.25
ILAK-25-HD (Keyed)	3,500	154	750	1000-0250 SRT	0.035	4.00	1.25

**ROD REACTION TORQUE** = TORQUE PER LB. x LOAD

## SERIES ILA-25 & ILAK-25

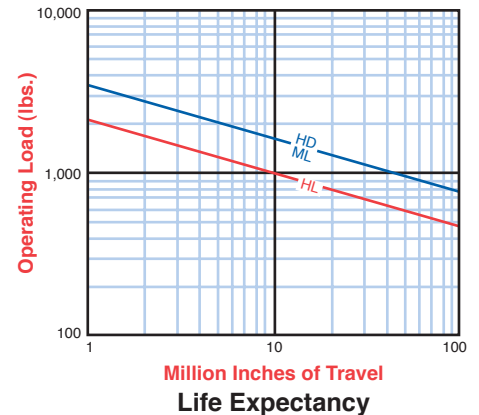
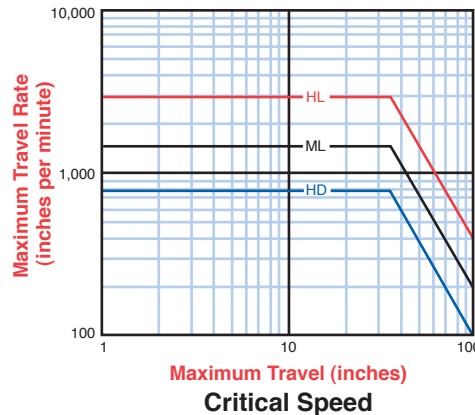
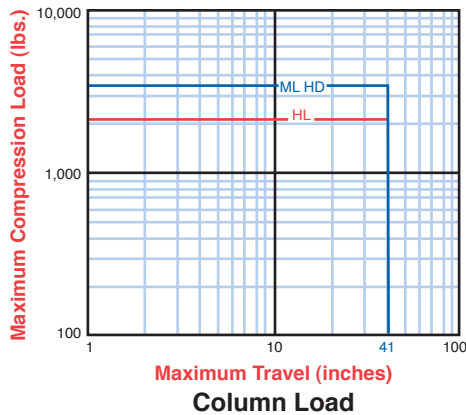

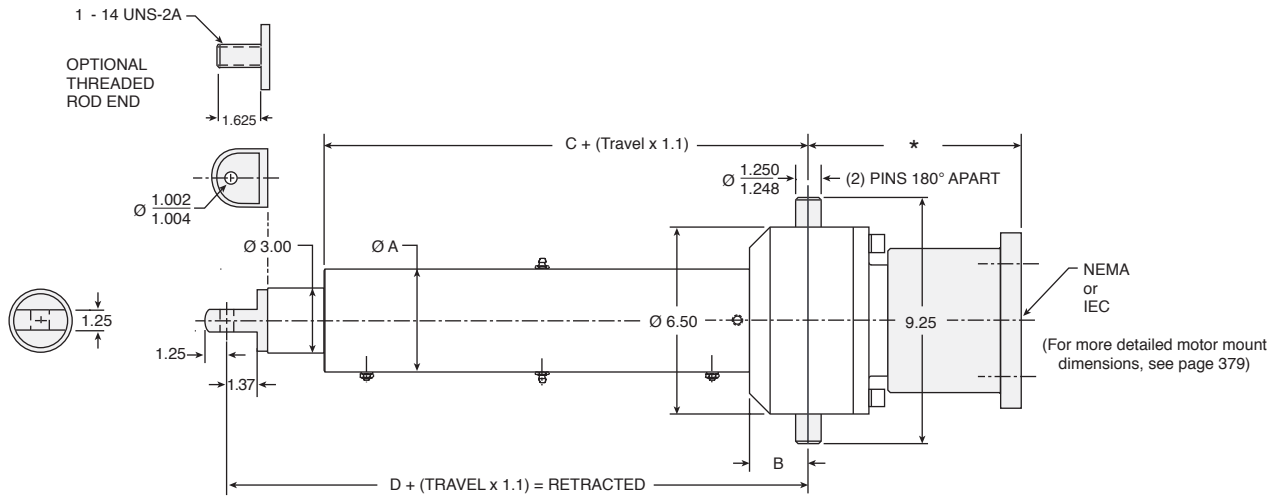

\* DIMENSION BASED ON MOTOR MOUNT, contact factory with your specific requirements.

ILA-100 & ILAK-100 BALL SCREW MODELS									
MODEL NUMBER	MAXIMUM LOAD [lb.]	MAX. INPUT TORQUE [in.-lb.]	MAX. TRAVEL RATE [in.-min.]	BALL SCREW	TORQUE PER LB. [in.-lb.]	DIMENSIONS			
						A	B	C	D
ILA-100 SL	2,500	830	3,750	1500-1875 SRT	0.332	4.00	2.50	16.00	19.00
ILA-100-HL	4,600	814	2,000	1500-1000 SRT	0.177	4.00	2.50	14.18	17.14
ILA-100-HD	9,000	756	946	1500-0473 SRT	0.084	4.00	2.50	14.18	17.14
ILAK-100 SL (Keyed)	2,500	830	3,750	1500-1875 SRT	0.332	6.50	2.00	17.50	20.50
ILAK-100-HL (Keyed)	4,600	814	2,000	1500-1000 SRT	0.177	6.50	2.00	14.18	17.14
ILAK-100-HD (Keyed)	9,000	756	946	1500-0473 SRT	0.084	6.50	2.00	14.18	17.14

**ROD REACTION TORQUE** = TORQUE PER LB. x LOAD

**NOTE:** CYLINDER IS SELF-LOWERING. INPUT SHAFT MUST BE SECURED TO PREVENT ROTATION.

## SERIES ILA-100 & ILAK-100

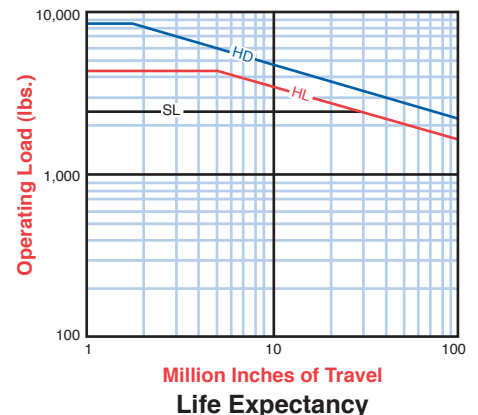
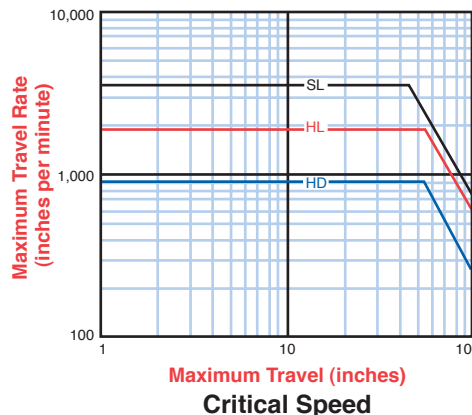
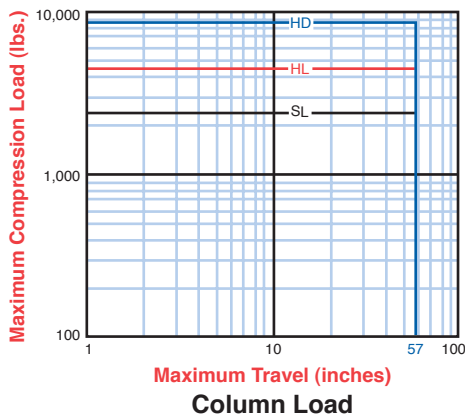

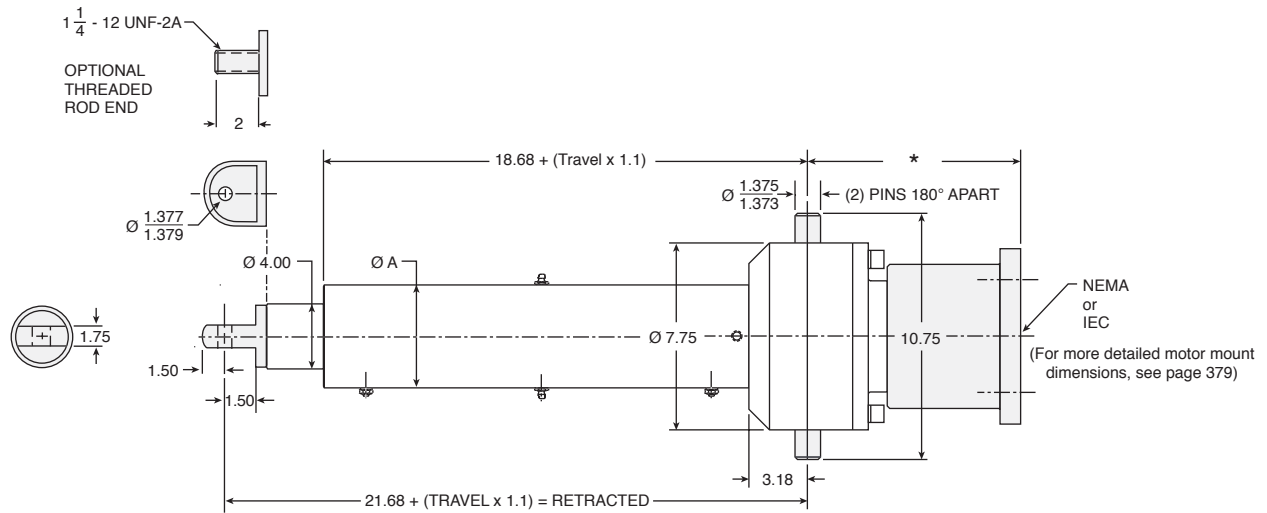

\* DIMENSION BASED ON MOTOR MOUNT, contact factory with your specific requirements.

ILA-200 & ILAK-200 BALL SCREW MODELS						
MODEL NUMBER	MAXIMUM LOAD [lb.]	MAX. INPUT TORQUE [in.-lb.]	MAX. TRAVEL RATE [in.-min.]	BALL SCREW	TORQUE PER LB. [in.-lb.]	DIMENSIONS
						A
ILA-200 HL	11,000	1,947	1,333	2250-1000 SRT	0.177	5.25
ILA-200-HD	21,000	1,848	667	2250-0500 SRT	0.088	5.25
ILAK-200 HL (Keyed)	11,000	1,947	1,337	2250-1000 SRT	0.177	7.50
ILAK-200 HD (Keyed)	21,000	1,848	667	2250-0500 SRT	0.088	7.50

**ROD REACTION TORQUE** = TORQUE PER LB. x LOAD

**NOTE:** CYLINDER IS SELF-LOWERING. INPUT SHAFT MUST BE SECURED TO PREVENT ROTATION.

**SERIES ILA-200 & ILAK-200**

