

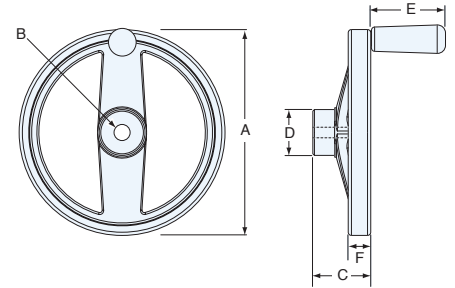

HANDWHEELS

A handwheel is a convenient solution for manually operating a jack when using machine screw jacks in intermittent positioning applications. Handwheels are available in a range of diameters from 4 to 10 inches and can be adapted for use on jacks from the MJ series up to the 20 ton capacity model.

NOTE: Handwheels do not include a brake. Handwheels are not recommended for use with ball screw jacks. When using handwheels with a jack that can back-drive (12:1 and lower) an additional locking mechanism may be required to prevent “creep”.



HANDWHEEL SPECIFICATIONS							
measurements in inches							
JACK SIZE	A	B	C	D	E	F	PART # METAL
MJ	4	.375	1 1/2	1 3/16	1 5/8	5/8	H043
1-MSJ	4	.50	1 1/2	1 3/16	1 5/8	5/8	H044
	6	.50	2	1 9/16	2 9/16	3/4	H064
2-MSJ	4	.50	1 1/2	1 3/16	1 5/8	5/8	H044
	6	.50	2	1 9/16	2 9/16	3/4	H064
2.5-MSJ	4	.50	1 1/2	1 3/16	1 5/8	5/8	H044
	6	.50	2	1 9/16	2 9/16	3/4	H064
5-MSJ	6	.75	2	1 9/16	2 9/16	3/4	H066
	8	.75	2 1/4	1 25/32	2 15/16	7/8	H086
	10	.75	3	2 1/4	3 15/16	1	H106
10-MSJ	8	1	2 1/4	1 25/32	2 15/16	7/8	H088
	10	1	3	2 1/4	3 15/16	1	H108
15-MSJ	8	1	2 1/4	1 25/32	2 15/16	7/8	H088
	10	1	3	2 1/4	3 15/16	1	H108
20-MSJ	8	1	2 1/4	1 25/32	2 15/16	7/8	H088
	10	1	3	2 1/4	3 15/16	1	H108

WORM GEAR SCREW JACK ACCESSORIES TECHNICAL DATA

HOW TO ORDER A JACK WITH A HANDWHEEL

EXAMPLE:

2.5-MSJ-U 24:1 / **H064-1** / SSE-2 / FT / 12.0 / S

