

INCH - CLOSED BEARINGS

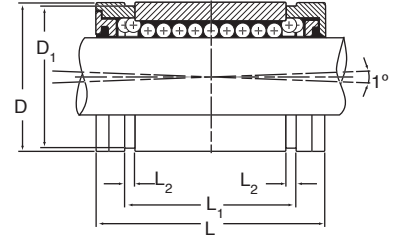

- Designed for use on end supported PowerTrax™ HG “L” shafting.
- Bearings are available with or without shaft seals.



Nominal Shaft Dia.	EXCEL™ Without Seal	EXCEL™ With Seal	No. of Ball Circuits	Housing Bore Dia. D	D ₁	L	L ₁	L ₂	Dynamic Load (lb.)		Static Load (lb.)	
									Normal	Maximum	Normal	Maximum
1/4"	XLEC04	XLEC04UU	4	0.5005/0.5000	0.4687	0.750/0.735	0.511/0.501	0.039	39	45	27	38
3/8"	XLEC06	XLEC06UU	4	0.6255/0.6250	0.5880	0.875/0.860	0.699/0.689	0.039	59	68	43	61
1/2"	XLEC08	XLEC08UU	4	0.8755/0.8750	0.8209	1.250/1.230	1.032/1.012	0.050	152	175	112	158
5/8"	XLEC10	XLEC10UU	5	1.1255/1.1250	1.0700	1.500/1.480	1.105/1.095	0.056	273	325	187	273
3/4"	XLEC12	XLEC12UU	6	1.2505/1.2500	1.1760	1.625/1.605	1.270/1.250	0.056	383	406	274	351
1"	XLEC16	XLEC16UU	6	1.5630/1.5625	1.4900	2.250/2.230	1.884/1.864	0.070	684	725	492	630
1 1/4"	XLEC20	XLEC20UU	6	2.0008/2.0000	1.8890	2.625/2.600	2.004/1.984	0.068	1017	1078	712	911
1 1/2"	XLEC24	XLEC24UU	6	2.3760/2.3750	2.2389	3.000/2.970	2.410/2.390	0.086	1298	1376	852	1091
2"	XLEC32	XLEC32UU	6	3.0010/3.0000	2.8379	4.000/3.960	3.193/3.163	0.105	2104	2230	1458	1866

INCH - OPEN BEARINGS



- Designed for use on fully supported PowerTrax™ HG “L” shafting.
- Longitudinal section equal to one ball circuit removed for support rail clearance.
- Standard bearing includes shaft seals.

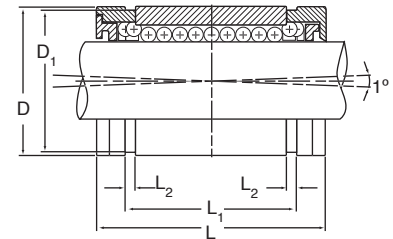
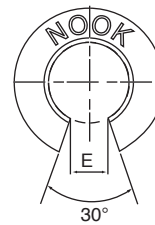

Nominal Shaft Dia.	EXCEL™ With Seal	No. of Ball Circuits	Housing Bore Dia. D	D ₁	L	L ₁	L ₂	E	Dynamic Load (lb.)		Static Load (lb.)	
									Normal	Maximum	Normal	Maximum
1/2"	XLEN08UU	3	0.8755/0.8750	0.8209	1.250/1.230	1.032/1.012	0.050	0.32	152	152	112	112
5/8"	XLEN10UU	4	1.1255/1.1250	1.0700	1.500/1.480	1.105/1.095	0.056	0.38	315	318	229	236
3/4"	XLEN12UU	5	1.2505/1.2500	1.1760	1.625/1.605	1.270/1.250	0.056	0.43	386	398	279	312
1"	XLEN16UU	5	1.5630/1.5625	1.4900	2.250/2.230	1.884/1.864	0.070	0.56	690	711	501	561
1 1/4"	XLEN20UU	5	2.0008/2.0000	1.8890	2.625/2.600	2.004/1.984	0.068	0.63	1025	1056	726	813
1 1/2"	XLEN24UU	5	2.3760/2.3750	2.2389	3.000/2.970	2.410/2.390	0.086	0.75	1307	1346	867	971
2"	XLEN32UU	5	3.0010/3.0000	2.8379	4.000/3.960	3.193/3.163	0.105	1.00	2121	2185	1485	1663

* DO NOT exceed 1/2 of rated values when load is applied through the bearing opening.

INCH - CLOSED SINGLE PILLOW BLOCKS



- Sealed at both ends, contains a closed unsealed EXCEL™ Bearing.
- Designed for use on end supported PowerTrax™ HG “L” shafting.

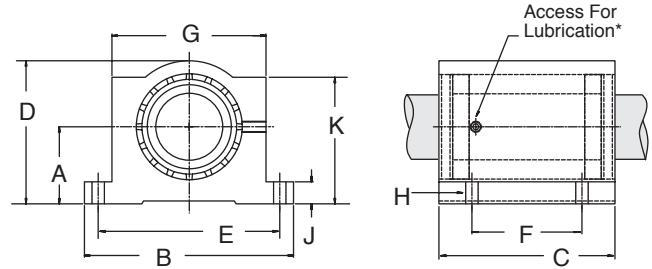

* Lubrication holes for blocks up to 1/2" have flush lube fitting; 5/8" and above are 1/4 – 28 tapped hole with set screw

Nominal Shaft Dia.	EXCEL™ Part No.	A ±0.001	B	C	D	E ±0.005	F ±0.005	G	H		J	K	Weight lbs.	Dynamic Load (lb.)		Static Load (lb.)	
									Bolt	Hole				Normal	Maximum	Normal	Maximum
3/8"	XEP-06	0.500	1 3/4"	1 5/16"	1 5/16"	1.437	0.875	1 1/8"	#6	0.17	3/16"	7/8"	0.12	59	68	43	61
1/2"	XEP-08	0.687	2"	1 11/16"	1 1/4"	1.688	1.000	1 3/8"	#6	0.17	1/4"	1 1/8"	0.20	152	175	112	158
5/8"	XEP-10	0.875	2 1/2"	1 15/16"	1 5/8"	2.125	1.125	1 3/4"	#8	0.19	9/32"	1 7/16"	0.50	273	325	187	273
3/4"	XEP-12	0.937	2 3/4"	2 1/16"	1 3/4"	2.375	1.250	1 7/8"	#8	0.19	5/16"	1 9/16"	0.60	383	406	274	351
1"	XEP-16	1.187	3 1/4"	2 13/16"	2 3/16"	2.875	1.750	2 3/8"	#10	0.22	3/8"	1 15/16"	1.20	684	725	492	630
1 1/4"	XEP-20	1.500	4"	3 5/8"	2 13/16"	3.500	2.000	3"	#10	0.22	7/16"	2 1/2"	2.50	1017	1078	712	911
1 1/2"	XEP-24	1.750	4 3/4"	4"	3 1/4"	4.125	2.500	3 1/2"	1/4"	0.28	1/2"	2 7/8"	3.80	1298	1376	852	1091
2"	XEP-32	2.125	6"	5"	4 1/16"	5.250	3.250	4 1/2"	3/8"	0.41	5/8"	3 5/8"	7.00	2104	2230	1458	1866

INCH - OPEN SINGLE PILLOW BLOCKS



- Sealed at both ends, contains an open, sealed EXCEL™ Bearing.
- Designed for use with fully supported PowerTrax™ HG “L” shafting
- Longitudinal section equal to one ball circuit removed for support rail clearance.

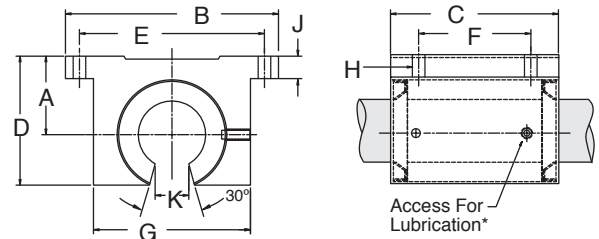

* Lubrication holes for blocks up to 1/2" have flush lube fitting; 5/8" and above are 1/4 – 28 tapped hole with set screw

Nominal Shaft Dia.	EXCEL™ Part No.	A ±0.001	B	C	D	E ±0.005	F ±0.005	G	H		J	K	Weight lbs.	Dynamic Load (lb.)		Static Load (lb.)	
									Bolt	Hole				Normal	Maximum	Normal	Maximum
1/2"	XEP-08-OPN	0.687	2"	1 1/2"	1 1/8"	1.688	1.000	1 3/8"	#6	0.17	1/4"	5/16"	0.20	152	152	112	112
5/8"	XEP-10-OPN	0.875	2 1/2"	1 3/4"	1 7/16"	2.125	1.125	1 3/4"	#8	0.19	9/32"	3/8"	0.40	315	318	229	236
3/4"	XEP-12-OPN	0.937	2 3/4"	1 7/8"	1 9/16"	2.375	1.250	1 7/8"	#8	0.19	5/16"	7/16"	0.50	386	398	279	312
1"	XEP-16-OPN	1.187	3 1/4"	2 5/8"	1 15/16"	2.875	1.750	2 3/8"	#10	0.22	3/8"	9/16"	1.00	690	711	501	561
1 1/4"	XEP-20-OPN	1.500	4"	3 3/8"	2 1/2"	3.500	2.000	3"	#10	0.22	7/16"	5/8"	2.10	1025	1056	726	813
1 1/2"	XEP-24-OPN	1.750	4 3/4"	3 3/4"	2 7/8"	4.125	2.500	3 1/2"	1/4"	0.28	1/2"	3/4"	3.20	1307	1346	867	971
2"	XEP-32-OPN	2.125	6"	4 3/4"	3 5/8"	5.250	3.250	4 1/2"	3/8"	0.41	5/8"	1"	6.00	2121	2185	1485	1663

* DO NOT exceed 1/2 of rated values when load is applied through the bearing opening.